

DOMEKT

Residential ventilation units



50 – 800 m³/h



Energy recovery

DOMEKT series are equipped with only the most efficient EC (electronically commutated) fans, high efficiency rotary and counterflow plate heat exchangers, filters with a huge filtering area and intelligent automation C6. All these components dramatically reduce energy consumption while maintaining a comfortable indoor climate.

Wide range

Depending on your installation plans, you can choose the most appropriate model: horizontal, vertical or fat. Non-freezing rotary or high efficiency counterflow plate heat exchangers are available. All units are equipped with electrical heaters. Water heater is available as an option. Detailed information on all units can be found in the DOMEKT selection software.

New casing technology EPP

The latest manufacturing technologies are applied to the following DOMEKT units: R 300 V, CF 150 F, CF 200 V, CF 300 V. The casing is produced from a special thermo-insulating sound absorbing material, which not only improves the casing's technical characteristics, but also enables more automatic processes of production.

The advantages of units produced using EPP (expanded polypropylene) technology:

- No thermal bridges, no condensation;
- Improved thermal insulation;
- Better aerodynamics;
- Better tightness;
- Reduced weight;
- Hydrophobic.



Integrated smart control system C6

Core philosophy behind the design of C6 was so the ventilation unit would operate properly without constant adjustments from the user. Factory predefined settings – simply "Plug and Play".

Remote control

The units can be controlled not only with the control panel, but also remotely via a web browser on your computer or mobile devices. The "Komfovent Home" application was specially developed for more convenient control.

Integration to BMS

All KOMFOVENT air handling units have fully implemented Modbus and BACnet protocols, which allows seamless integration with any desired Building Management Systems.

Low noise level

Only perfectly balanced fans with unique geometry are used in DOMEKT units. All of the unit's components are aerodynamically matched. Housings padded with mineral wool and the use of special composite materials ensure silent operation of these units.

Reliability and durability

Double protection from corrosion – the housing of the units is made of galvanized steel with a powder coated finish. Fan motors are protected from humidity and dust, and equipped with long-life bearings.

DOMEKT

Range review

Domekt R



Sizes and capacities of Domekt R units

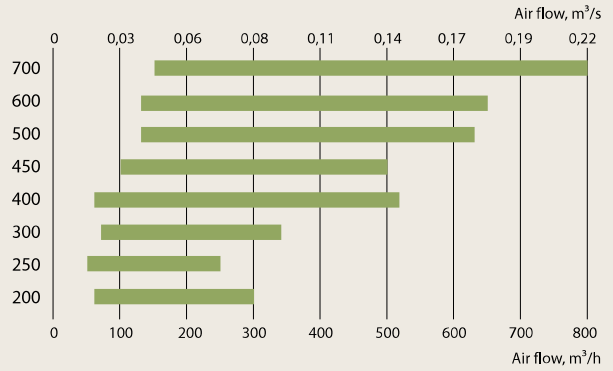

Domekt CF



Sizes and capacities of Domekt CF units

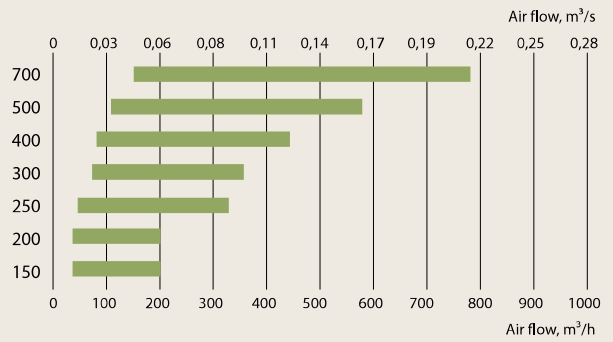

Domekt S



Sizes and capacities of Domekt S units

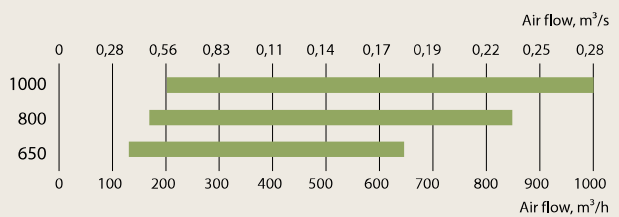

Advantages of the units

Efficient heat exchanger

Under the normal operating conditions, the rotary heat exchanger does not freeze: even at outdoor temperatures below -20 °C, no additional warming up of the outdoor air required. Also, the rotary heat exchanger effectively saves the cold during the summer, significantly reducing the cost of air conditioning.

Low noise level

Silently operating fans and sound insulation ensures low noise level.

Air humidity balance

Under normal operating conditions, condensation does not form in the rotary heat exchanger during the process of heat exchange, because most of the humidity is returned to the premises. Excess humidity is removed outside. The air in the premises is less dry and the air humidity balance is maintained during cold periods. As condensation does not form, drainage is not necessary – this simplifies the mounting of the unit.

Energy efficient EC rotor motor

Rotary heat exchangers are equipped with EC motors, which ensure the smooth rotor operation and control.

Enthalpy energy saving

As option it is possible to order units with enthalpic counter flow plate heat exchanger which recovers heat or cold and also controls humidity in premises during winter time.

Heat energy saving and dehumidification

The counter flow plate heat exchanger maintains high efficiency when outdoor air temperature is above -4°C. The humidity in the air of the room is condensed, so this heat exchanger is most suitable for high humidity rooms.

Long-term efficient operation

Counterflow plate heat exchangers are made of special polystyrene. The absence of movable parts ensures effective heat exchange and longevity.

Totally separated air flows

The supply and exhaust air flows are separated, thus making it possible to utilize the heat of the extracted foul air.

Low noise level

Silently operating fans and sound insulation ensures low noise level.

- Height is only 297 mm / 350 mm – easy to choose the place for installation.
- Units are complemented with fastening profiles and vibration-absorbing holders.
- Safe and handy design of removable cover ensures easy fixing of cover at different opening levels to carry out maintenance and service inspection.

- Air handling units have integrated control system.
- Control panel may be installed in any user-convenient place.
- Control panel display enables setting the operation parameters of the unit and monitoring them.
- There is a possibility to complement and control the duct mounted cooling section.

Domekt R

Air handling units with rotary heat exchanger

Sizes and capacities of Domekt R units

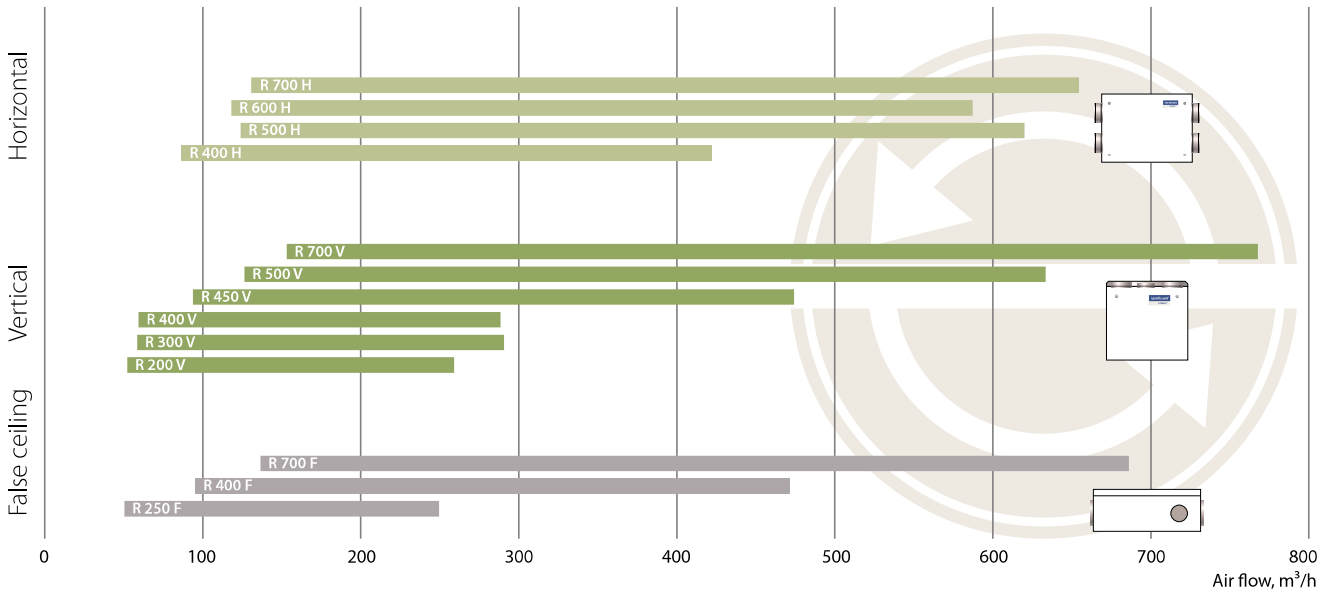

Modifications of Domekt R units

Unit	Heat exchanger		Supply/exhaust air filter class		Heater			Cooler		Inspection side				Control system / panel		
	L/A	L/AZ	F7	M5	HE	HW	HCW	CW	DX	R1	R2	L1	L2	C4 C4.1	C6 C6.1	C6.2
Domekt R 200 V	●		○	●	●	△	△			○		○		●		
Domekt R 250 F	●	○	○	●	●	△	△	△	△	○	○	○	○		○	○
Domekt R 300 V	●	○	○	●	●	△	△	△	△	○		○			○	○
Domekt R 400 V	●	○	○	●	●	△	△	△	△	○		○			○	○
Domekt R 400 H	●	○	○	●	●	△	△	△	△	○		○			○	○
Domekt R 400 F	●	○	○	●	●	△	△	△	△	○	○	○	○		○	○
Domekt R 450 V	●	○	○	●	●	△	△	△	△	○		○			○	○
Domekt R 500 V/H	●	○	○	●	●	△	△	△	△	○		○			○	○
Domekt R 600 H	●	○	○	●	●	△	△	△	△	○		○			○	○
Domekt R 700 V	●	○	○	●	●	△	△	△	△	○		○			○	○
Domekt R 700 H	●	○	○	●	●	△	△	△	△	○		○			○	○
Domekt R 700 F	●	○	○	●	●	△	△	△	△	○	○	○	○		○	○

● standard equipment ○ possible choice △ ordered separately duct heater/cooler

The markings are explained on p. 7.

Domekt R 200 V

Maximal air flow, m ³ /h	258
Panel thickness, mm	25
Unit weight, kg	42
Supply voltage, V	1~230
Maximal operating current, A	HE 4,7
Thermal efficiency of heat recovery, %	82
Reference flow rate, m ³ /s	0,05
Reference pressure difference, Pa	50
SPI, W/(m ³ /h)	0,35
Filters dimensions BxHxL, mm	285x130x46
Electric power input of the fan drive at reference flow rate, W	27
Electric power input of the fan drive at maximum flow rate, W	66
Electric air heater capacity, kW / Δt, °C	0,8 / 12,3
Control panel	C4.1
Maintenance space, mm	300

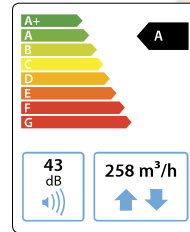

The photo is intended for informational purposes only. exact details may vary.



Acoustic data

A-weighted sound power level L_{WAr} dB(A) at reference flow rate

Supply inlet	53
Supply outlet	66
Exhaust inlet	53
Exhaust outlet	66
Casing	43

A-weighted sound pressure level L_{pAr} dB(A)

10 m² normally isolated room, distance from casing – 3 m.

Surroundings	33
--------------	----

Performance

Unit with standard equipment

Air flow rate (m³/s)

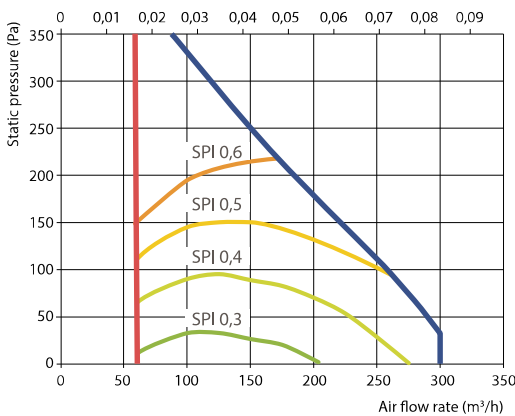

Temperature efficiency

Outside temperature, °C	Winter				
	-23	-15	-10	-5	0
After heat exchanger, °C	11,6	13,5	14,6	15,8	16,9

indoor +22°C, 20 % RH

Shown as left (L1)

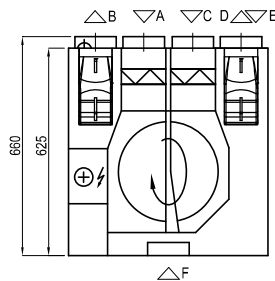

Shown as right (R1)

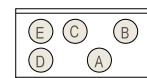

- A outdoor intake
- B supply air
- C extract indoor
- D exhaust air
- E additional extraction connection (by-pass – extraction without heat recovery)
- F kitchen hood connection (by-pass – extraction without heat recovery)

Accessories (p. 120)

Closing damper	AGUJ-M-125+LF230/LM230
Silencer	A/D AGS-125-50-600-M
	B/C AGS-125-50-900-M
Water heater	DH-125
PPU	PPU-HW-3R-15-0,4-W1
2-way valve (water heater)	VVP47.10-0,4

Water cooler	DHCW-125
2-way valve (water cooler)	VVP47.10-1,6
Kitchen hood	KH
Decorative panel	DP
Air distribution box	OSD-200 VE-125
Outdoor grill	LD-125

Domekt R 250 F

Maximal air flow, m ³ /h	250
Panel thickness, mm	50
Unit weight, kg	40
Supply voltage, V	1~230
Maximal operating current, A	HE 6,1
Thermal efficiency of heat recovery, %	80
Reference flow rate, m ³ /s	0,049
Reference pressure difference, Pa	50
SPI, W/(m ³ /h)	0,47
Filters dimensions B×H×L, mm	278×258×46
Electric power input of the fan drive at reference flow rate, W	40
Electric power input of the fan drive at maximum flow rate, W	90
Electric air heater capacity, kW / Δt, °C	1/15,9
Control panel	C6.1 / C6.2
Maintenance space, mm	300

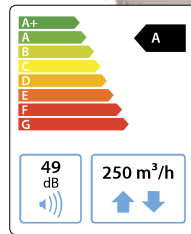

The photo is intended for informational purposes only. exact details may vary.

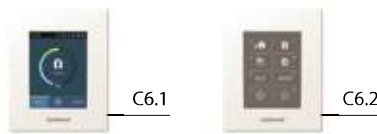

Acoustic data

A-weighted sound power level L_{WA} , dB(A) at reference flow rate

Supply inlet	61
Supply outlet	70
Exhaust inlet	61
Exhaust outlet	70
Casing	49

A-weighted sound pressure level L_{pM} , dB(A)

10 m² normally isolated room, distance from casing – 3 m.

Surroundings	38
--------------	----

Performance

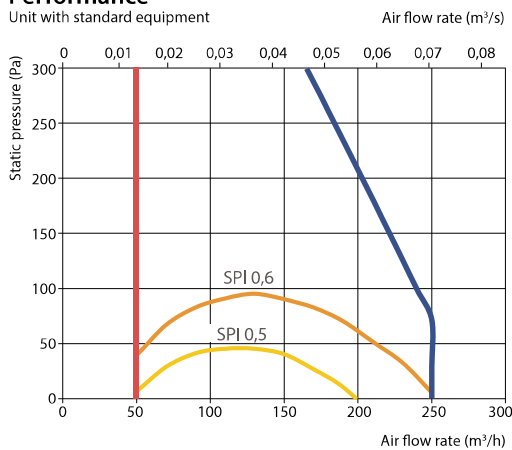

Temperature efficiency

Outside temperature, °C	Winter					Summer		
	-23	-15	-10	-5	0	25	30	35
After heat exchanger, °C	10,7	12,7	14,0	15,2	16,5	22,8	24,0	25,3

indoor +22°C, 20 % RH

Shown as right (R2)

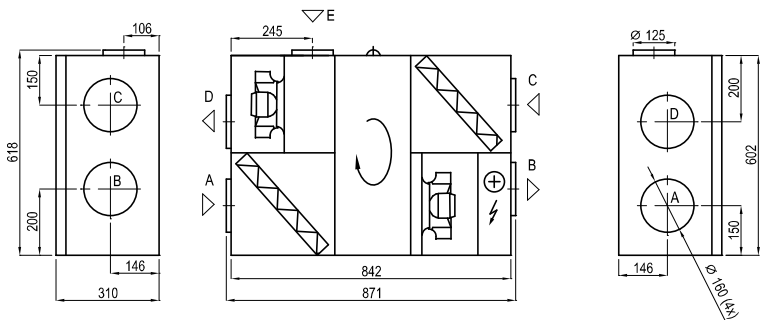

Shown as left (L2)

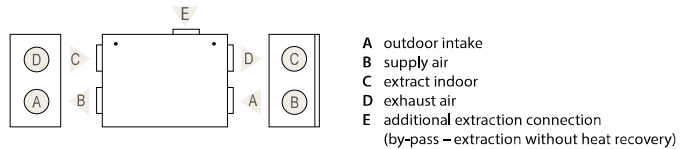

Accessories (p. 120)

Closing damper	AGUJ-M-160+LF230/LM230
Silencer	A/D AGS-160-50-600-M B/C AGS-160-50-900-M
Water heater	DH-160
PPU	PPU-HW-3R-15-0,4-W1

2-way valve (water heater)	VVP47.10-0,4
Water cooler	DCW-0,2-1 / DHCW-160
2-way valve (water cooler)	VVP47.10-1,6
DX cooler	DCF-0,2-1

Domekt R 300 V

Maximal air flow, m ³ /h	289
Panel thickness, mm	30
Unit weight, kg	28
Supply voltage, V	1~230
Maximal operating current, A	HE4
Thermal efficiency of heat recovery, %	84
Reference flow rate, m ³ /s	0,056
Reference pressure difference, Pa	50
SPI, W/(m ³ /h)	0,27
Filters dimensions BxHxL, mm	290x205x46
Electric power input of the fan drive at reference flow rate, W	27
Electric power input of the fan drive at maximum flow rate, W	72
Electric air heater capacity, kW / Δt, °C	0,5/6,9
Control panel	C6.1 / C6.2
Maintenance space, mm	450

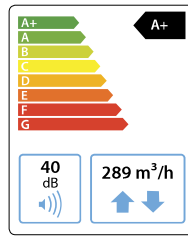

The photo is intended for informational purposes only. exact details may vary.



Acoustic data

A-weighted sound power level L_{Wav} dB(A) at reference flow rate

Supply inlet	52
Supply outlet	60
Exhaust inlet	52
Exhaust outlet	60
Casing	40

A-weighted sound pressure level L_{pav} dB(A)

10 m² normally isolated room, distance from casing – 3 m.

Surroundings	30
--------------	----

Performance

Unit with standard equipment

Air flow rate (m³/s)

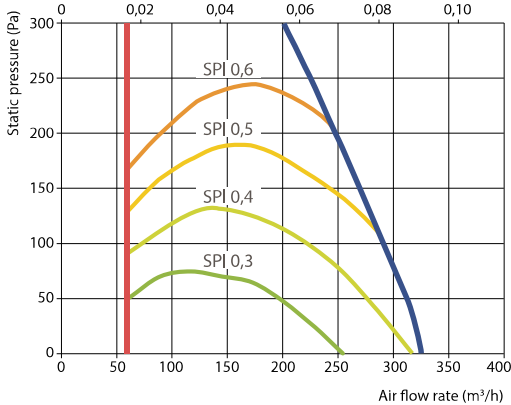

Temperature efficiency

	Winter					Summer		
Outside temperature, °C	-23	-15	-10	-5	0	25	30	35
After heat exchanger, °C	14,7	16,0	16,8	17,6	18,4	22,5	23,3	24,1

indoor +22°C, 20% RH

Shown as left (L1)

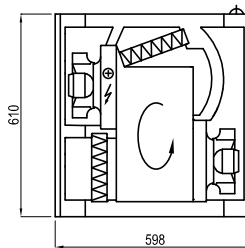

Shown as right (R1)

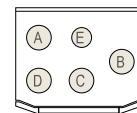

- A outdoor intake
- B supply air
- C extract indoor
- D exhaust air
- E additional extraction connection (by-pass – extraction without heat recovery)

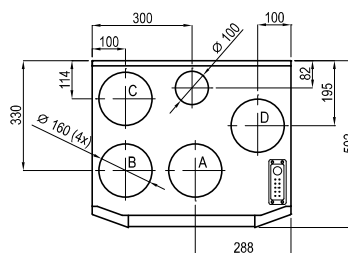

Accessories (p. 120)

Closing damper	AGUJ-M-160+LF230/LM230
	A/D AGS-160-50-600-M
Silencer	B/C AGS-160-50-900-M
Water heater	DH-160
PPU	PPU-HW-3R-15-0,4-W1

2-way valve (water heater)	VVP47.10-0,4
Water cooler	DCW-0,4-3 / DHCW-160
2-way valve (water cooler)	VVP47.10-1,6
DX cooler	DCF-0,4-3

Domekt R 400 V

Maximal air flow, m ³ /h	287
Panel thickness, mm	25
Unit weight, kg	50
Supply voltage, V	1~230
Maximal operating current, A	HE 5,5
Thermal efficiency of heat recovery, %	86
Reference flow rate, m ³ /s	0,056
Reference pressure difference, Pa	50
SPI, W/(m ³ /h)	0,24
Filters dimensions BxHxL, mm	450x210x46
Electric power input of the fan drive at reference flow rate, W	23
Electric power input of the fan drive at maximum flow rate, W	71
Electric air heater capacity, kW / Δt, °C	1 / 13,8
Control panel	C6.1 / C6.2
Maintenance space, mm	450

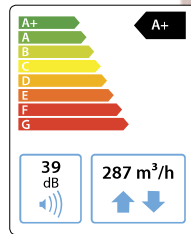

The photo is intended for informational purposes only. exact details may vary.

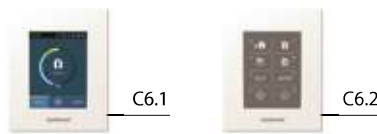

Acoustic data

A-weighted sound power level L_{WA} , dB(A)
at reference flow rate

Supply inlet	52
Supply outlet	65
Exhaust inlet	52
Exhaust outlet	65
Casing	39

A-weighted sound pressure level L_{pM} , dB(A)
10 m² normally isolated room, distance from casing – 3 m.

Surroundings	29
--------------	----

Performance

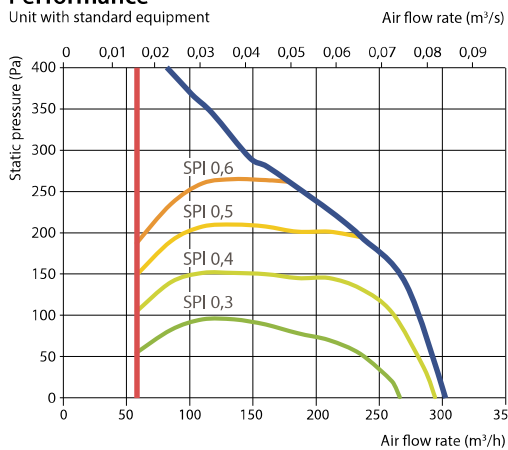

Temperature efficiency

Outside temperature, °C	Winter					Summer		
	-23	-15	-10	-5	0	25	30	35
After heat exchanger, °C	14,8	16,1	16,9	17,7	18,5	22,5	23,3	24,1

indoor +22°C, 20 % RH

Shown as left (L1)

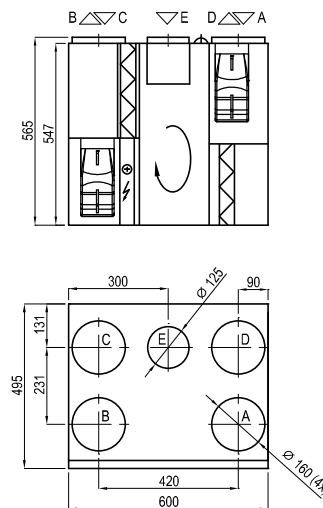

Shown as right (R1)

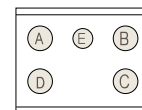

- A outdoor intake
- B supply air
- C extract indoor
- D exhaust air
- E additional extraction connection (by-pass – extraction without heat recovery)

Accessories (p. 120)

Closing damper	AGUJ-M-160+LF230/LM230	2-way valve (water heater)	VVP47.10-0,4
Silencer	A/D AGS-160-50-600-M	Water cooler	DCW-0,4-3 / DHCW-160
	B/C AGS-160-50-900-M	2-way valve (water cooler)	VVP47.10-1,6
Water heater	DH-160	DX cooler	DCF-0,4-3
PPU	PPU-HW-3R-15-0,4-W1		

Domekt R 400 H

Maximal air flow, m ³ /h	422
Panel thickness, mm	50
Unit weight, kg	45
Supply voltage, V	1~230
Maximal operating current, A	HE 6,3
Thermal efficiency of heat recovery, %	84
Reference flow rate, m ³ /s	0,082
Reference pressure difference, Pa	50
SPI, W/(m ³ /h)	0,37
Filters dimensions BxHxL, mm	410x200x46
Electric power input of the fan drive at reference flow rate, W	55
Electric power input of the fan drive at maximum flow rate, W	126
Electric air heater capacity, kW / Δt, °C	1/9,4
Control panel	C6.1 / C6.2
Maintenance space, mm	650

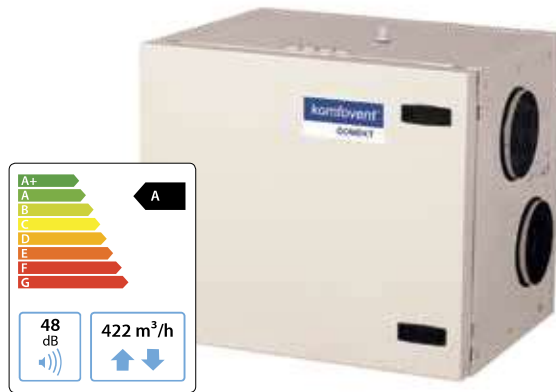

The photo is intended for informational purposes only. exact details may vary.



Acoustic data

A-weighted sound power level L_{Wav} dB(A) at reference flow rate

Supply inlet	60
Supply outlet	69
Exhaust inlet	60
Exhaust outlet	69
Casing	48

A-weighted sound pressure level L_{pav} dB(A)

10 m² normally isolated room, distance from casing – 3 m.

Surroundings	37
--------------	----

Performance

Unit with standard equipment

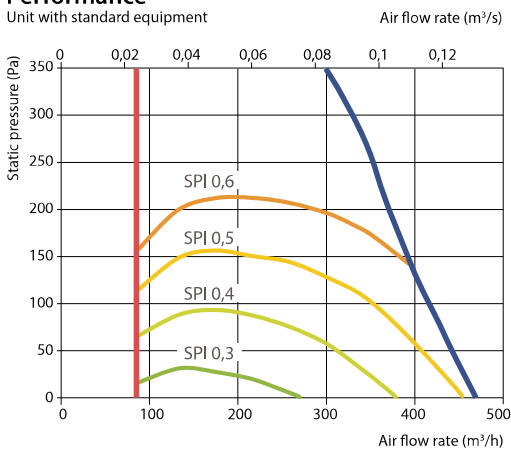

Temperature efficiency

Outside temperature, °C	Winter					Summer		
	-23	-15	-10	-5	0	25	30	35
After heat exchanger, °C	13,4	14,9	15,9	16,8	17,8	22,6	23,5	24,5

indoor +22°C, 20 % RH

Shown as right (R1)

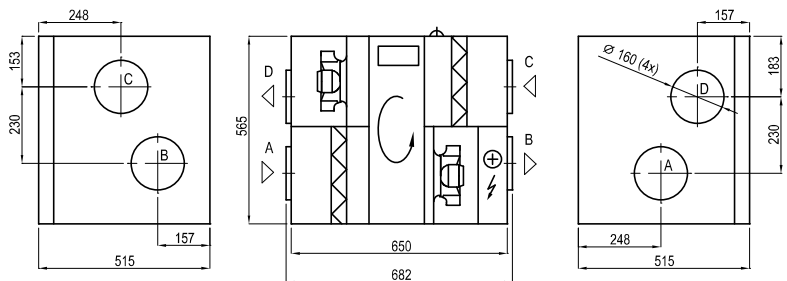

Shown as left (L1)

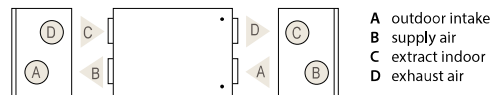

Accessories (p. 120)

Closing damper	AGUJ-M-160+LF230/LM230
	A/D AGS-160-50-600-M
Silencer	B/C AGS-160-50-900-M
	DH-160
Water heater	PPU-HW-3R-15-0,4-W1

2-way valve (water heater)	VVP47.10-0,4
Water cooler	DCW-0,4-3 / DHCW-160
2-way valve (water cooler)	VVP47.10-1,6
DX cooler	DCF-0,4-3

Domekt R 400 F

Maximal air flow, m ³ /h	472
Panel thickness, mm	50
Unit weight, kg	67
Supply voltage, V	1~230
Maximal operating current, A	HE 7,3
Thermal efficiency of heat recovery, %	81
Reference flow rate, m ³ /s	0,092
Reference pressure difference, Pa	50
SPI, W/(m ³ /h)	0,43
Filters dimensions BxHxL, mm	278x258x46
Electric power input of the fan drive at reference flow rate, W	72
Electric power input of the fan drive at maximum flow rate, W	165
Electric air heater capacity, kW / Δt, °C	1 / 8,4
Control panel	C6.1 / C6.2
Maintenance space, mm	300



The photo is intended for informational purposes only. exact details may vary.

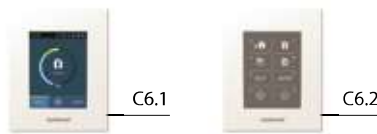

Acoustic data

A-weighted sound power level L_{WA} , dB(A) at reference flow rate

Supply inlet	63
Supply outlet	72
Exhaust inlet	63
Exhaust outlet	72
Casing	52

A-weighted sound pressure level L_{pA} , dB(A)

10 m² normally isolated room, distance from casing – 3 m.

Surroundings	41
--------------	----

Performance

Unit with standard equipment

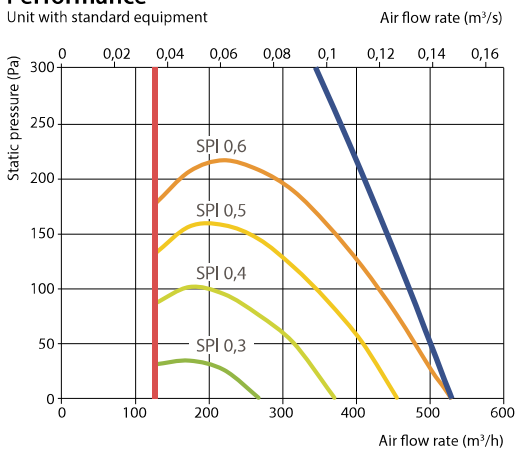

Temperature efficiency

Outside temperature, °C	Winter					Summer		
	-23	-15	-10	-5	0	25	30	35
After heat exchanger, °C	11,4	13,3	14,5	15,7	16,8	22,7	23,9	25,1

indoor +22°C, 20 % RH

Shown as right (R1)

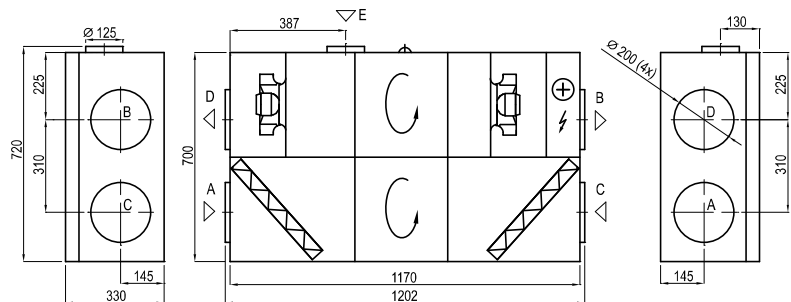

Shown as left (L1)

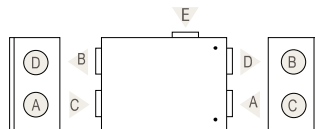

- A outdoor intake
- B supply air
- C extract indoor
- D exhaust air
- E additional extraction connection (by-pass – extraction without heat recovery)

Accessories (p. 120)

Closing damper	AGUJ-M-200+LF230/LM230
Silencer	A/D AGS-200-50-600-M B/C AGS-200-50-900-M
Water heater	DH-200
PPU	PPU-HW-3R-15-0,63-W1

2-way valve (water heater)	VVP47.10-0,63
Water cooler	DCW-0,4-3 / DHCW-200
2-way valve (water cooler)	VVP47.15-2,5
DX cooler	DCF-0,4-3

Domekt R 450 V

Maximal air flow, m ³ /h	472
Panel thickness, mm	50
Unit weight, kg	60
Supply voltage, V	1~230
Maximal operating current, A	HE 7,2
Thermal efficiency of heat recovery, %	85
Reference flow rate, m ³ /s	0,092
Reference pressure difference, Pa	50
SPI, W/(m ³ /h)	0,44
Filters dimensions BxHxL, mm	470x240x46
Electric power input of the fan drive at reference flow rate, W	72
Electric power input of the fan drive at maximum flow rate, W	170
Electric air heater capacity, kW / Δt, °C	1/8,4
Control panel	C6.1 / C6.2
Maintenance space, mm	500



The photo is intended for informational purposes only. exact details may vary.



Acoustic data

A-weighted sound power level L_{WAr} dB(A) at reference flow rate

Supply inlet	58
Supply outlet	72
Exhaust inlet	58
Exhaust outlet	72
Casing	39

A-weighted sound pressure level L_{pAr} dB(A)

10 m² normally isolated room, distance from casing – 3 m.

Surroundings	29
--------------	----

Performance

Unit with standard equipment

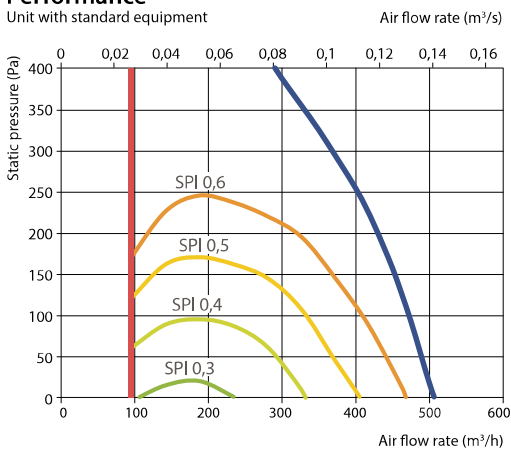

Temperature efficiency

	Winter					Summer		
Outside temperature, °C	-23	-15	-10	-5	0	25	30	35
After heat exchanger, °C	14,0	15,4	16,3	17,2	18,1	22,5	23,4	24,3

indoor +22°C, 20% RH

Shown as left (L1)

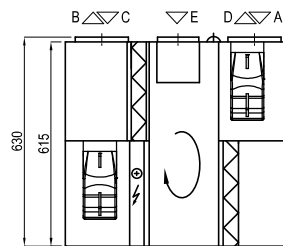

Shown as right (R1)

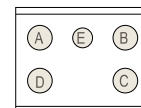

- A outdoor intake
- B supply air
- C extract indoor
- D exhaust air
- E additional extraction connection (by-pass – extraction without heat recovery)

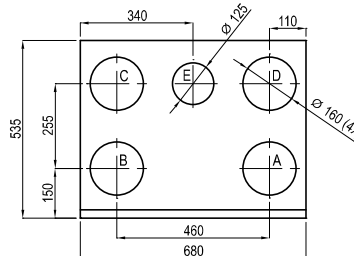

Accessories (p. 120)

Closing damper	AGUJ-M-160+LF230/LM230
Silencer	A/D AGS-160-50-600-M B/C AGS-160-50-900-M
Water heater	DH-160
PPU	PPU-HW-3R-15-0,4-W1

2-way valve (water heater)	VVP47.10-0,4
Water cooler	DCW-0,5-3 / DHCW-160
2-way valve (water cooler)	VVP47.10-1,6
DX cooler	DCF-0,5-3

Domekt R 500 V

Maximal air flow, m ³ /h	630
Panel thickness, mm	50
Unit weight, kg	113
Supply voltage, V	1~230
Maximal operating current, A	HE 7,3
Thermal efficiency of heat recovery, %	85
Reference flow rate, m ³ /s	0,123
Reference pressure difference, Pa	50
SPI, W/(m ³ /h)	0,35
Filters dimensions BxHxL, mm	540x260x46
Electric power input of the fan drive at reference flow rate, W	77
Electric power input of the fan drive at maximum flow rate, W	144
Electric air heater capacity, kW / Δt, °C	1 / 6,3
Control panel	C6.1 / C6.2
Maintenance space, mm	1050

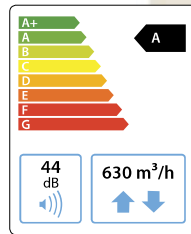

The photo is intended for informational purposes only. exact details may vary.

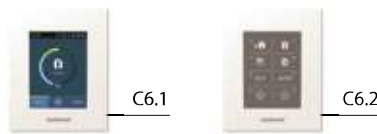

Acoustic data

A-weighted sound power level L_{WA} , dB(A) at reference flow rate

Supply inlet	57
Supply outlet	65
Exhaust inlet	57
Exhaust outlet	66
Casing	44

A-weighted sound pressure level L_{pM} , dB(A)

10 m² normally isolated room, distance from casing – 3 m.

Surroundings	34
--------------	----

Temperature efficiency

	Winter					Summer		
Outside temperature, °C	-23	-15	-10	-5	0	25	30	35
After heat exchanger, °C	14,0	15,4	16,3	17,2	18,1	22,5	23,4	24,3

indoor +22°C, 20 % RH

Shown as left (L1)

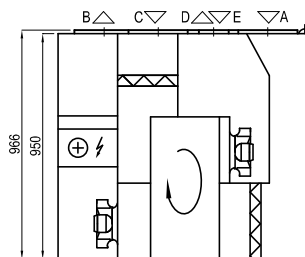

Shown as right (R1)

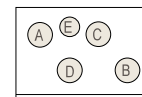

- A outdoor intake
- B supply air
- C extract indoor
- D exhaust air
- E additional extraction connection (by-pass – extraction without heat recovery)

Performance

Unit with standard equipment

Air flow rate (m³/s)

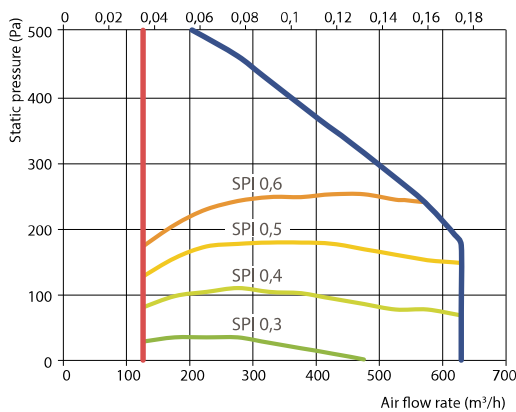

Accessories (p. 120)

Closing damper	AGUJ-M-250+LF230/LM230
Silencer	A/D AGS-250-50-600-M
	B/C AGS-250-50-900-M
Water heater	DH-250
PPU	PPU-HW-3R-15-0,63-W1

2-way valve (water heater)	VVP47.10-0,63
Water cooler	DCW-0,5-3 / DHCW-250
2-way valve (water cooler)	VVP47.15-2,5
DX cooler	DCF-0,5-3

Domekt R 500 H

Maximal air flow, m ³ /h	617
Panel thickness, mm	50
Unit weight, kg	86
Supply voltage, V	1~230
Maximal operating current, A	HE7,3
Thermal efficiency of heat recovery, %	85
Reference flow rate, m ³ /s	0,120
Reference pressure difference, Pa	50
SPI, W/(m ³ /h)	0,32
Filters dimensions BxHxL, mm	540x260x46
Electric power input of the fan drive at reference flow rate, W	73
Electric power input of the fan drive at maximum flow rate, W	180
Electric air heater capacity, kW / Δt, °C	1/6,4
Control panel	C6.1 / C6.2
Maintenance space, mm	950

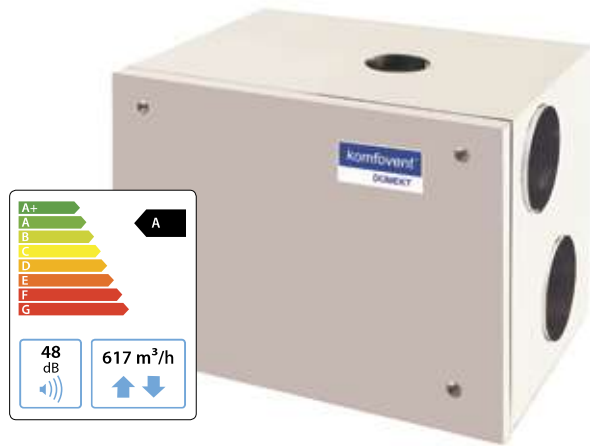

The photo is intended for informational purposes only. exact details may vary.



Acoustic data

A-weighted sound power level L_{WAr} dB(A) at reference flow rate

Supply inlet	59
Supply outlet	68
Exhaust inlet	59
Exhaust outlet	68
Casing	48

A-weighted sound pressure level L_{pAr} dB(A)

10 m² normally isolated room, distance from casing – 3 m.

Surroundings	37
--------------	----

Performance

Unit with standard equipment

Air flow rate (m³/s)

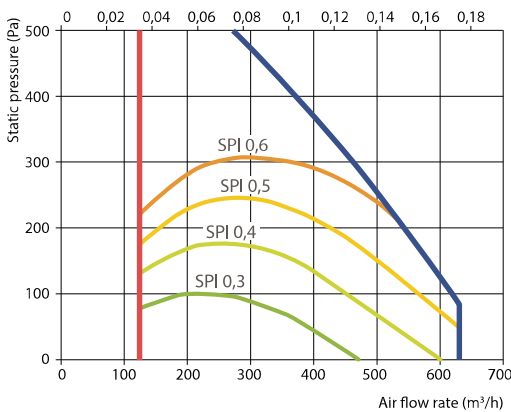

Temperature efficiency

Outside temperature, °C	Winter					Summer		
	-23	-15	-10	-5	0	25	30	35
After heat exchanger, °C	14,0	15,5	16,3	17,2	18,1	22,5	23,4	24,3

indoor +22°C, 20% RH

Shown as right (R1)

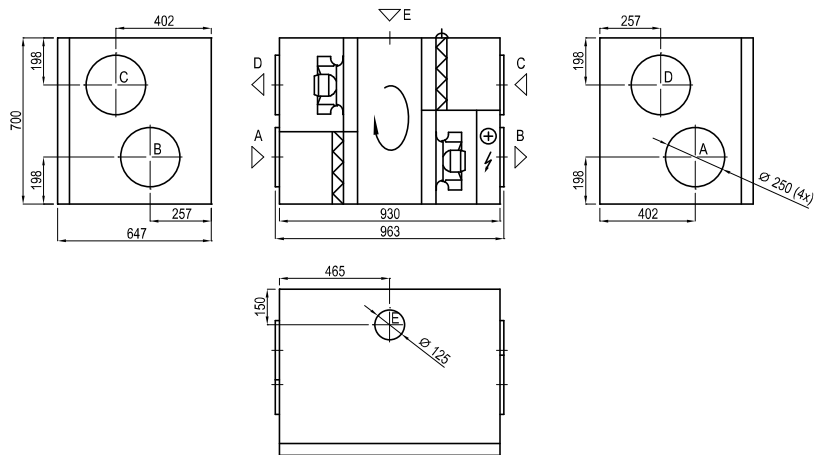

Shown as left (L1)

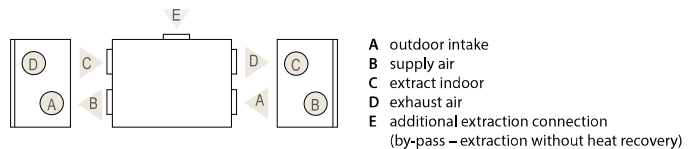

Accessories (p. 120)

Closing damper	AGUJ-M-250+LF230/LM230
	A/D AGS-250-50-600-M
Silencer	B/C AGS-250-50-900-M
Water heater	DH-250
PPU	PPU-HW-3R-15-0,63-W1

2-way valve (water heater)	VVP47.10-0,63
Water cooler	DCW-0,5-3 / DHCW-250
2-way valve (water cooler)	VVP47.15-2,5
DX cooler	DCF-0,5-3

Domekt R 600 H

Maximal air flow, m ³ /h	584
Panel thickness, mm	50
Unit weight, kg	80
Supply voltage, V	1~230
Maximal operating current, A	HE 7,3
Thermal efficiency of heat recovery, %	83
Reference flow rate, m ³ /s	0,114
Reference pressure difference, Pa	50
SPI, W/(m ³ /h)	0,37
Filters dimensions BxHxL, mm	475x235x46
Electric power input of the fan drive at reference flow rate, W	77
Electric power input of the fan drive at maximum flow rate, W	179
Electric air heater capacity, kW / Δt, °C	1 / 6,8
Control panel	C6.1 / C6.2
Maintenance space, mm	500



The photo is intended for informational purposes only. exact details may vary.



Acoustic data

A-weighted sound power level L_{WA}, dB(A) at reference flow rate

Supply inlet	58
Supply outlet	67
Exhaust inlet	58
Exhaust outlet	67
Casing	47

A-weighted sound pressure level L_{PA}, dB(A)

10 m² normally isolated room, distance from casing – 3 m.

Surroundings	36
--------------	----

Performance

Unit with standard equipment

Air flow rate (m³/s)

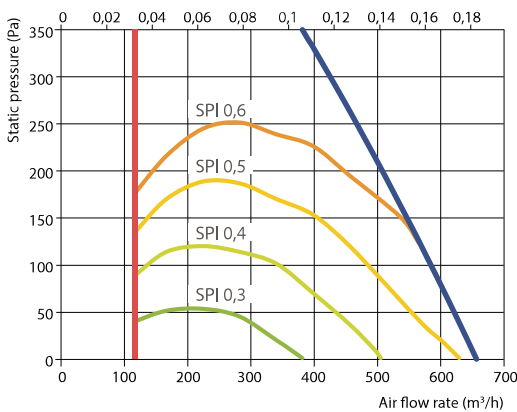

Temperature efficiency

Outside temperature, °C	Winter					Summer		
	-23	-15	-10	-5	0	25	30	35
After heat exchanger, °C	13,1	14,7	15,7	16,7	17,6	22,6	23,6	24,6

indoor +22°C, 20 % RH

Shown as right (R1)

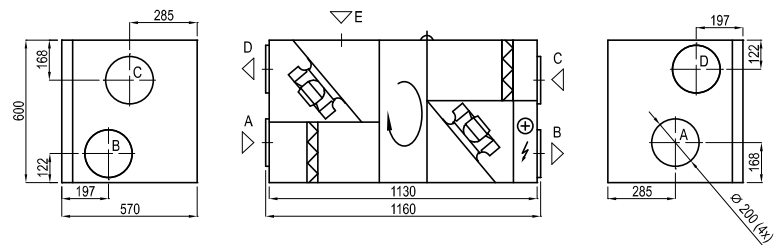

Shown as left (L1)

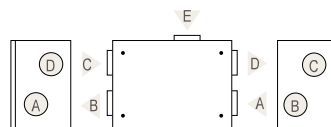

- A outdoor intake
- B supply air
- C extract indoor
- D exhaust air
- E additional extraction connection (by-pass – extraction without heat recovery)

Accessories (p. 120)

Closing damper	AGUJ-M-200+LF230/LM230
Silencer	A/D AGS-200-50-600-M
	B/C AGS-200-50-900-M
Water heater	DH-200
PPU	PPU-HW-3R-15-0,63-W1

2-way valve (water heater)	VVP47.10-0,63
Water cooler	DCW-0,7-5 / DHCW-200
2-way valve (water cooler)	VVP47.15-2,5
DX cooler	DCF-0,7-5
Cooling unit	MOU-18HFN6-KA8243

Domekt R 700 V

Maximal air flow, m ³ /h	764
Panel thickness, mm	50
Unit weight, kg	114
Supply voltage, V	1~230
Maximal operating current, A	HE11,7
Thermal efficiency of heat recovery, %	83
Reference flow rate, m ³ /s	0,149
Reference pressure difference, Pa	50
SPI, W/(m ³ /h)	0,26
Filters dimensions BxHxL, mm	540x260x46
Electric power input of the fan drive at reference flow rate, W	73
Electric power input of the fan drive at maximum flow rate, W	179
Electric air heater capacity, kW / Δt, °C	2 / 10,4
Control panel	C6.1 / C6.2
Maintenance space, mm	1050



The photo is intended for informational purposes only. exact details may vary.



Acoustic data

A-weighted sound power level L_{WAr} dB(A) at reference flow rate

Supply inlet	55
Supply outlet	63
Exhaust inlet	55
Exhaust outlet	63
Casing	44

A-weighted sound pressure level L_{pAr} dB(A)

10 m² normally isolated room, distance from casing – 3 m.

Surroundings	34
--------------	----

Performance

Unit with standard equipment

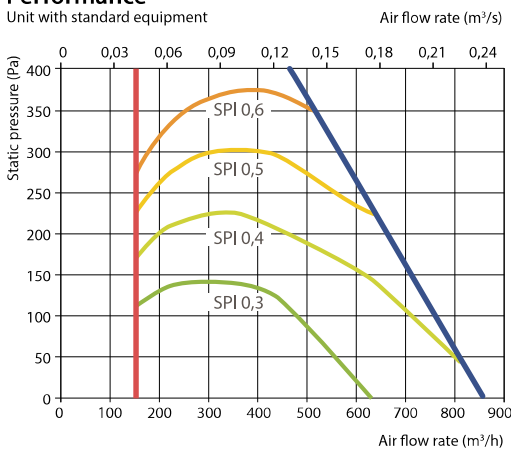

Temperature efficiency

	Winter					Summer		
Outside temperature, °C	-23	-15	-10	-5	0	25	30	35
After heat exchanger, °C	13,1	14,7	15,7	16,7	17,7	22,6	23,6	24,6

indoor +22°C, 20 % RH

Shown as left (L1)

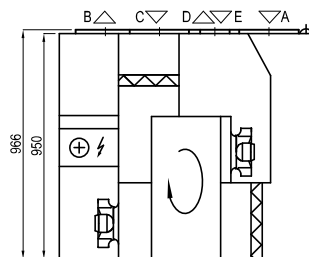

Shown as right (R1)

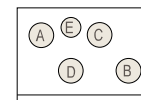

- A outdoor intake
- B supply air
- C extract indoor
- D exhaust air
- E additional extraction connection (by-pass – extraction without heat recovery)

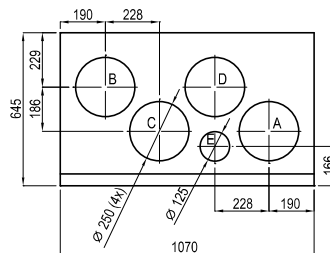

Accessories (p. 120)

Closing damper	AGUJ-M-250+LF230/LM230
	A/D AGS-250-50-600-M
Silencer	B/C AGS-250-50-900-M
Water heater	DH-250
PPU	PPU-HW-3R-15-0,63-W1

2-way valve (water heater)	VVP47.10-0,63
Water cooler	DCW-0,7-5 / DHCW-250
2-way valve (water cooler)	VVP47.15-2,5
DX cooler	DCF-0,7-5
Cooling unit	MOU-18HFN6-KA8243

Domekt R 700 H

Maximal air flow, m ³ /h	696
Panel thickness, mm	50
Unit weight, kg	87
Supply voltage, V	1~230
Maximal operating current, A	HE 11,7
Thermal efficiency of heat recovery, %	84
Reference flow rate, m ³ /s	0,135
Reference pressure difference, Pa	50
SPI, W/(m ³ /h)	0,34
Filters dimensions BxHxL, mm	540x260x46
Electric power input of the fan drive at reference flow rate, W	89
Electric power input of the fan drive at maximum flow rate, W	176
Electric air heater capacity, kW / Δt, °C	2 / 11,4
Control panel	C6.1 / C6.2
Maintenance space, mm	950

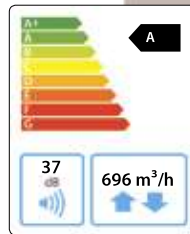

The photo is intended for informational purposes only. exact details may vary.



Acoustic data

A-weighted sound power level L_{WA}, dB(A) at reference flow rate

Supply inlet	60
Supply outlet	69
Exhaust inlet	60
Exhaust outlet	69
Casing	48

A-weighted sound pressure level L_{PA}, dB(A)

10 m² normally isolated room, distance from casing – 3 m.

Surroundings	37
--------------	----

Temperature efficiency

Outside temperature, °C	Winter					Summer		
	-23	-15	-10	-5	0	25	30	35
After heat exchanger, °C	13,6	15,1	16,0	16,9	17,9	22,6	23,5	24,4

indoor +22°C, 20 % RH

Shown as right (R1)

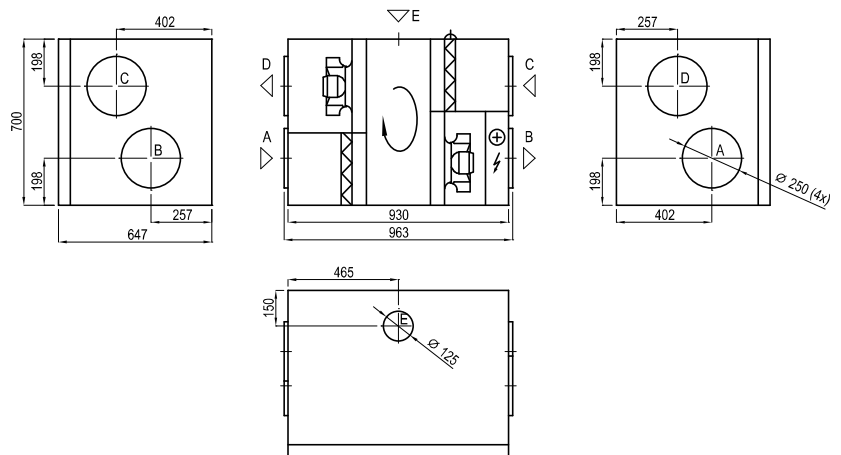

Shown as left (L1)

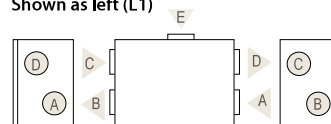

- A outdoor intake
- B supply air
- C extract indoor
- D exhaust air
- E additional extraction connection (by-pass – extraction without heat recovery)

Performance

Unit with standard equipment

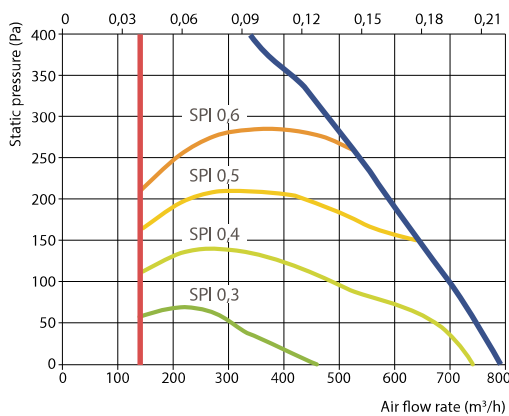

Accessories (p. 120)

Closing damper	AGUJ-M-250+LF230/LM230
Silencer	A/D AGS-250-50-600-M B/C AGS-250-50-900-M
Water heater	DH-250
PPU	PPU-HW-3R-15-0,63-W1

2-way valve (water heater)	VVP47.10-0,63
Water cooler	DCW-0,7-5 / DHCW-250
2-way valve (water cooler)	VVP47.15-2,5
DX cooler	DCF-0,7-5
Cooling unit	MOU-18HFN6-KA8243

Domekt R 700 F

Maximal air flow, m ³ /h	686
Panel thickness, mm	50
Unit weight, kg	93
Supply voltage, V	1~230
Maximal operating current, A	HE11,7
Thermal efficiency of heat recovery, %	83
Reference flow rate, m ³ /s	0,133
Reference pressure difference, Pa	50
SPI, W/(m ³ /h)	0,30
Filters dimensions BxHxL, mm	370x360x46
Electric power input of the fan drive at reference flow rate, W	76
Electric power input of the fan drive at maximum flow rate, W	176
Electric air heater capacity, kW / Δt, °C	2 / 11,6
Control panel	C6.1 / C6.2
Maintenance space, mm	430

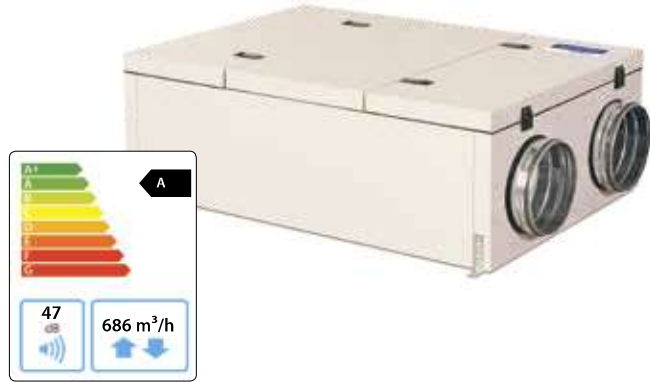

The photo is intended for informational purposes only. exact details may vary.



Acoustic data

A-weighted sound power level L_{WA}, dB(A)
at reference flow rate

Supply inlet	54
Supply outlet	67
Exhaust inlet	54
Exhaust outlet	67
Casing	47

A-weighted sound pressure level L_{PA}, dB(A)

10 m² normally isolated room, distance from casing – 3 m.

Surroundings	36
--------------	----

Performance

Unit with standard equipment

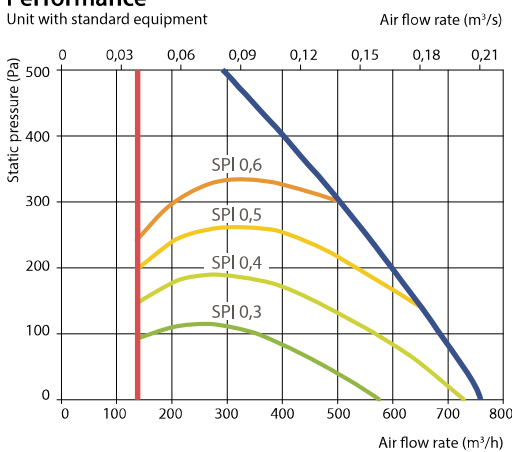

Temperature efficiency

	Winter					Summer		
Outside temperature, °C	-23	-15	-10	-5	0	25	30	35
After heat exchanger, °C	12,6	14,3	15,3	16,4	17,4	22,6	23,7	24,7

indoor +22°C, 20 % RH

Shown as left (L1)

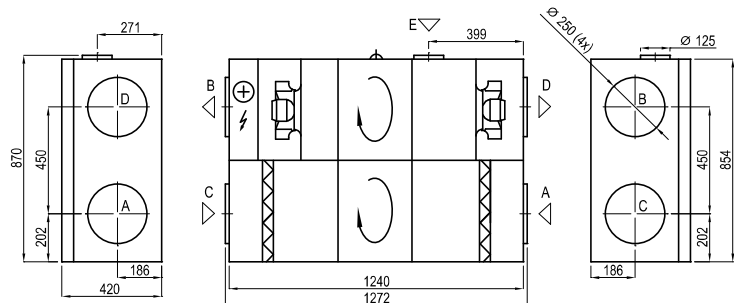

Shown as right (R1)

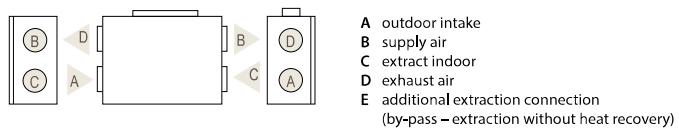

Accessories (p. 120)

Closing damper	AGUJ-M-250+LF230/LM230
Silencer	A/D AGS-250-50-600-M
	B/C AGS-250-50-900-M
Water heater	DH-250
PPU	PPU-HW-3R-15-0,63-W1

2-way valve (water heater)	VVP47.10-0,63
Water cooler	DCW-0,7-5 / DHCW-250
2-way valve (water cooler)	VVP47.15-2,5
DX cooler	DCF-0,7-5
Cooling unit	MOU-18HFN6-KA8243

Domekt CF

Air handling units with counterflow plate heat exchangers

Sizes and capacities of Domekt CF units

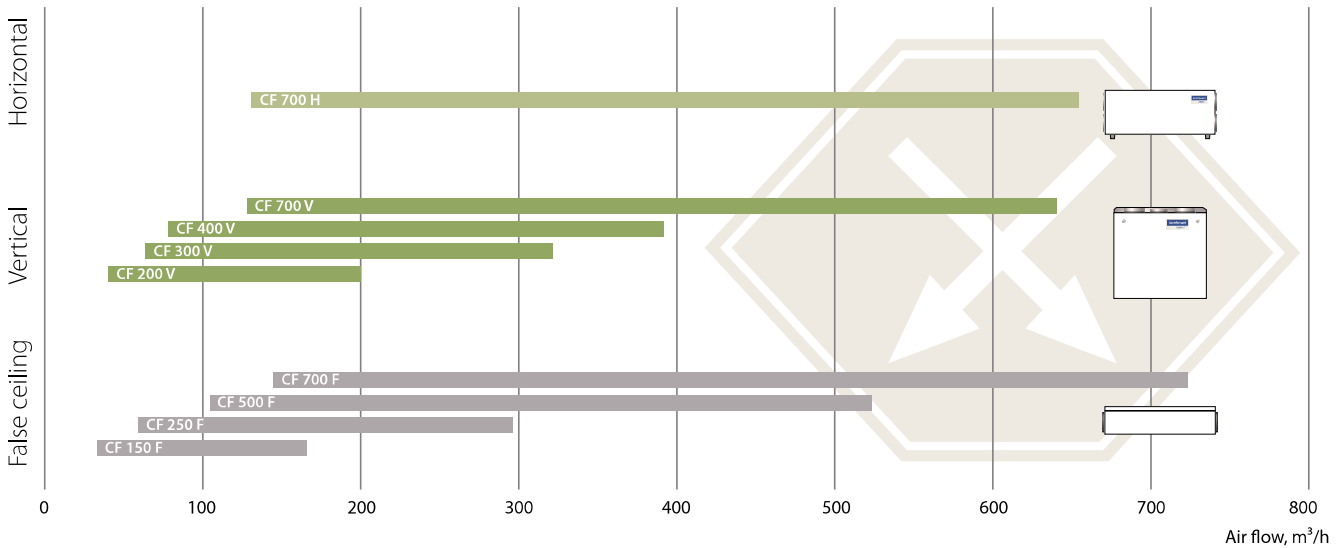

Modifications of Domekt CF units

Unit	Heat exchanger		Supply/exhaust air filter class		Preheater	Heater			Cooler		Inspection side				Bypass	Control system/ panel C6	
	Condensing	Enthalpy	F7	M5	HE	HE	HW	HCW	CW	DX	R1	R2	L1	L2	Inner	C6.1	C6.2
Domekt CF 150 F	●	○	○	●	●	●	△	△	△	△		○	○		●	○	○
Domekt CF 200 V	●	○	○	●	●	●	△	△	△	△	○		○		●	○	○
Domekt CF 250 F	●	○	○	●	●	●	△	△	△	△	○	○	○	○	●	○	○
Domekt CF 300 V	●	○	○	●	●	●	△	△	△	△	○		○		●	○	○
Domekt CF 400 V	●	○	○	●	●	●	△	△	△	△	○		○		●	○	○
Domekt CF 500 F	●	○	○	●	●	●	△	△	△	△	○	○	○	○	●	○	○
Domekt CF 700 V	●	○	○	●	●	●	△	△	△	△	○		○		●	○	○
Domekt CF 700 H	●	○	○	●	●	●	△	△	△	△	○		○		●	○	○
Domekt CF 700 F	●	○	○	●	●	●	△	△	△	△	○	○	○	○	●	○	○

● standard equipment ○ possible choice △ ordered separately duct heater/cooler

The markings are explained on p. 7.

Domekt CF 150 F/H

Maximal air flow, m ³ /h	165
Panel thickness, mm	30
Unit weight, kg	29
Supply voltage, V	1~230
Maximal operating current, A	6,1
Thermal efficiency of heat recovery, %	88
Reference flow rate, m ³ /s	0,032
Reference pressure difference, Pa	50
SPI, W/(m ³ /h)	0,26
Filters dimensions BxHxL, mm	260x232x46
Electric power input of the fan drive at reference flow rate, W	12
Electric power input of the fan drive at maximum flow rate, W	18
Electric air heater capacity, kW / Δt, °C	0,5 / 12
Electric preheater capacity, kW / Δt, °C	0,75 / 18
Control panel	C6.1 / 6.2
Maintenance space, mm	300

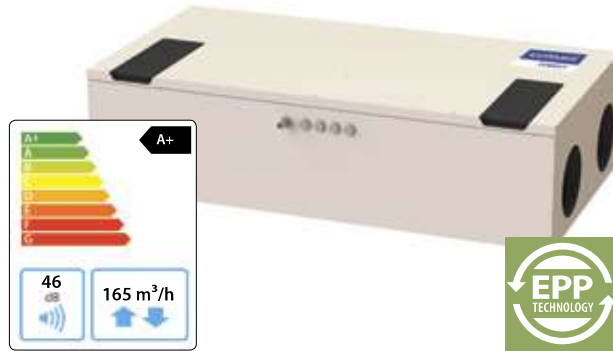

The photo is intended for informational purposes only. exact details may vary.



Acoustic data

A-weighted sound power level L_{WA}, dB(A)
at reference flow rate

Supply inlet	48
Supply outlet	59
Exhaust inlet	48
Exhaust outlet	59
Casing	46

A-weighted sound pressure level L_{PA}, dB(A)

10 m² normally isolated room, distance from casing – 3 m.

Surroundings	35
--------------	----

Temperature efficiency

Outside temperature, °C	Winter					Summer		
	-23	-15	-10	-5	0	25	30	35
After heat exchanger*, °C	18,4*	18,8*	19,3*	19,3	19,5	22,3	22,9	23,5

indoor +22°C, 20% RH.

* calculations made after evaluation of the preheater.

Shown as right (R2)

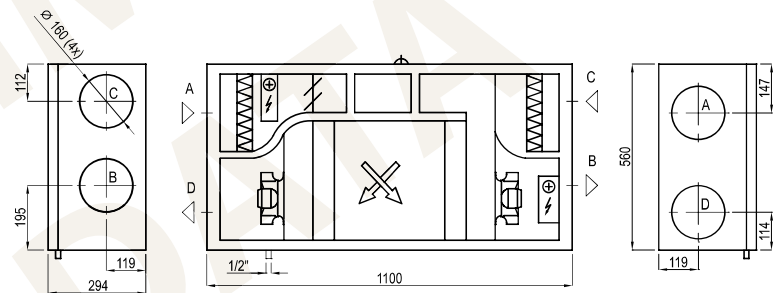

Shown as left (L1)

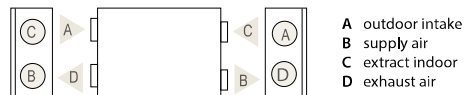

Performance

Unit with standard equipment

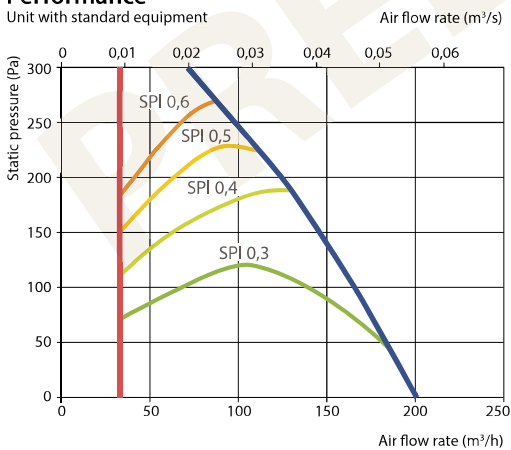

Accessories (p. 120)

Closing damper	AGUJ-M-160+LF230/LM230
Silencer	A/D AGS-160-50-600-M B/C AGS-160-50-900-M
Water heater	DH-160
PPU	PPU-HW-3R-15-0,4-W2

2-way valve (water heater)	VVP47.10-0,4
Water cooler	DCW-0,2-1 / DHCW-160
2-way valve (water cooler)	VVP47.10-1,6
DX cooler	DCF-0,2-1

Domekt CF 200 V

Maximal air flow, m ³ /h	200
Panel thickness, mm	30
Unit weight, kg	40
Supply voltage, V	1~230
Maximal operating current, A	HE 8,3
Thermal efficiency of heat recovery, %	93
Reference flow rate, m ³ /s	0,039
Reference pressure difference, Pa	50
SPI, W/(m ³ /h)	0,24
Filters dimensions BxHxL, mm	365x135x46
Electric power input of the fan drive at reference flow rate, W	16
Electric power input of the fan drive at maximum flow rate, W	34
Electric air heater capacity, kW / Δt, °C	0,5 / 9,9
Electric preheater capacity, kW / Δt, °C	1 / 19,8
Control panel	C6.1 / 6.2
Maintenance space, mm	600

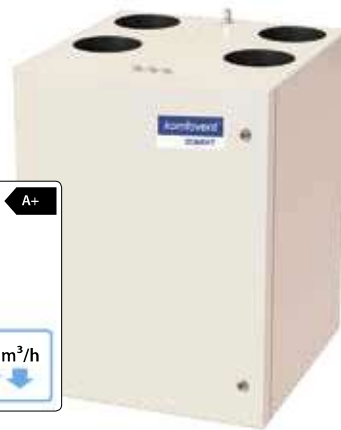
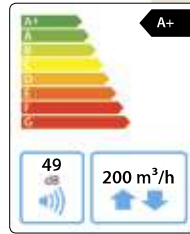

Acoustic data

A-weighted sound power level L_{WA} , dB(A) at reference flow rate

Supply inlet	49
Supply outlet	62
Exhaust inlet	49
Exhaust outlet	62
Casing	49

A-weighted sound pressure level L_{pM} , dB(A)

10 m² normally isolated room, distance from casing – 3 m.

Surroundings	38
--------------	----

Temperature efficiency

Outside temperature, °C	Winter					Summer		
	-23	-15	-10	-5	0	25	30	35
After heat exchanger*, °C	19,9*	19,9*	19,9*	19,9	20,3	22,2	22,6	23

indoor +22°C, 20 % RH.

* calculations made after evaluation of the preheater.

Shown as right (R1)

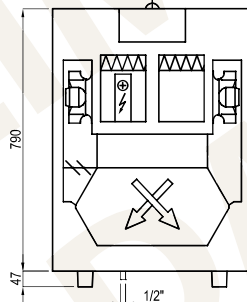

Shown as left (L1)

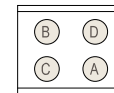
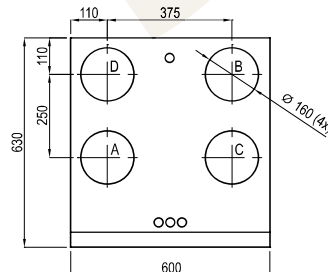

- A outdoor intake
- B supply air
- C extract indoor
- D exhaust air

Performance

Unit with standard equipment

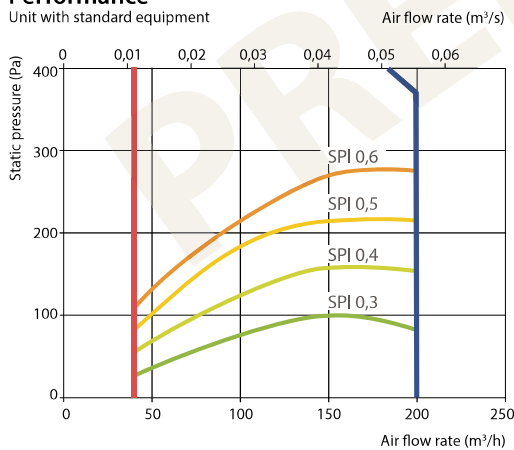

Accessories (p. 120)

Closing damper	AGUJ-M-160+LF230/LM230
Silencer	A/D AGS-160-50-600-M
	B/C AGS-160-50-900-M
Water heater	DH-160
PPU	PPU-HW-3R-15-0,4-W2

2-way valve (water heater)	VVP47.10-0,4
Water cooler	DCW-0,2-1 / DHCW-160
2-way valve (water cooler)	VVP47.10-1,6
DX cooler	DCF-0,2-1

The photo is intended for informational purposes only. exact details may vary.

Domekt CF 250 F

Maximal air flow, m ³ /h	295
Panel thickness, mm	30
Unit weight, kg	52
Supply voltage, V	1~230
Maximal operating current, A	8,3
Thermal efficiency of heat recovery, %	86
Reference flow rate, m ³ /s	0,0574
Reference pressure difference, Pa	50
SPI, W/(m ³ /h)	0,3
Filters dimensions BxHxL, mm	265x250x46
Electric power input of the fan drive at reference flow rate, W	32
Electric power input of the fan drive at maximum flow rate, W	89
Electric air heater capacity, kW / Δt, °C	0,5 / 6,7
Electric preheater capacity, kW / Δt, °C	1 / 13,4
Control panel	C6.1 / 6.2
Maintenance space, mm	300

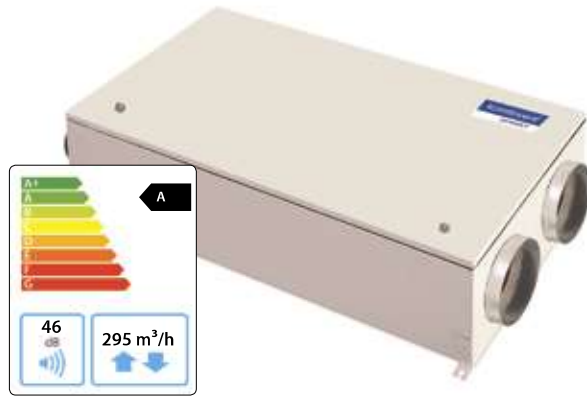

The photo is intended for informational purposes only. exact details may vary.



Acoustic data

A-weighted sound power level L_{WAr} dB(A) at reference flow rate

Supply inlet	53
Supply outlet	65
Exhaust inlet	54
Exhaust outlet	65
Casing	46

A-weighted sound pressure level L_{pAr} dB(A)

10 m² normally isolated room, distance from casing – 3 m.

Surroundings	35
--------------	----

Performance

Unit with standard equipment

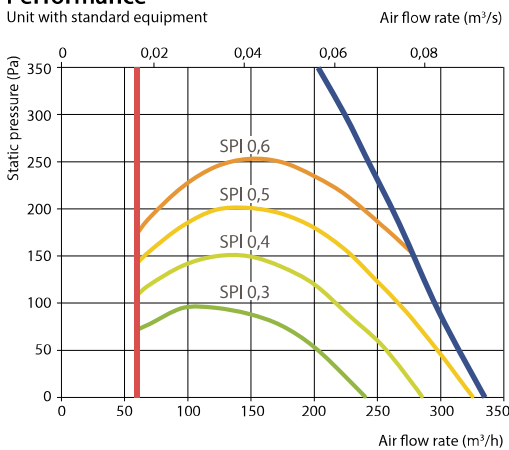

Temperature efficiency

Outside temperature, °C	Winter					Summer		
	-23	-15	-10	-5	0	25	30	35
After heat exchanger*, °C	16,1*	17,0*	17,0*	17,0	17,9	22,6	23,5	24,4

indoor +22°C, 20% RH.

* calculations made after evaluation of the preheater.

Shown as right (R1)

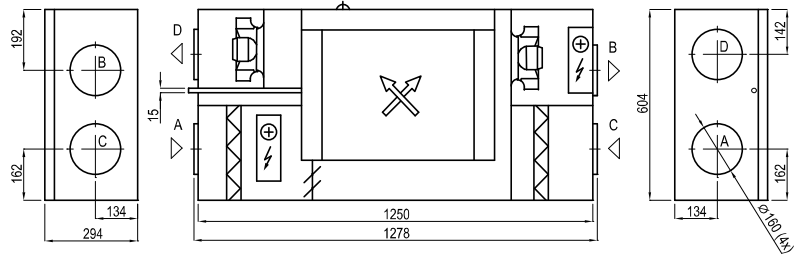

Shown as left (L1)

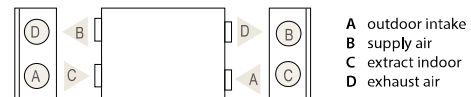

Accessories (p. 120)

Closing damper	AGUJ-M-160+LF230/LM230
Silencer	A/D AGS-160-50-600-M B/C AGS-160-50-900-M
Water heater	DH-160
PPU	PPU-HW-3R-15-0,4-W1

2-way valve (water heater)	VVP47.10-0,4
Water cooler	DCW-0,2-1 / DHCW-160
2-way valve (water cooler)	VVP47.10-1,6
DX cooler	DCF-0,2-1

Domekt CF 300 V

Maximal air flow, m ³ /h	320
Panel thickness, mm	30
Unit weight, kg	40
Supply voltage, V	1~230
Maximal operating current, A	HE 10,5
Thermal efficiency of heat recovery, %	89
Reference flow rate, m ³ /s	0,062
Reference pressure difference, Pa	50
SPI, W/(m ³ /h)	0,32
Filters dimensions BxHxL, mm	365x135x46
Electric power input of the fan drive at reference flow rate, W	33
Electric power input of the fan drive at maximum flow rate, W	71
Electric air heater capacity, kW / Δt, °C	0,5 / 6,2
Electric preheater capacity, kW / Δt, °C	1,5 / 18,6
Control panel	C6.1 / 6.2
Maintenance space, mm	600



The photo is intended for informational purposes only. exact details may vary.

Acoustic data

A-weighted sound power level L_{WA}, dB(A) at reference flow rate

Supply inlet	51
Supply outlet	47
Exhaust inlet	51
Exhaust outlet	64
Casing	50

A-weighted sound pressure level L_{pA}, dB(A)

10 m² normally isolated room, distance from casing – 3 m.

Surroundings	39
--------------	----

Temperature efficiency

Outside temperature, °C	Winter					Summer		
	-23	-15	-10	-5	0	25	30	35
After heat exchanger*, °C	18,8*	18,8*	18,8*	18,8	19,4	22,4	23	23,6

indoor +22°C, 20 % RH.
* calculations made after evaluation of the preheater.

Shown as right (R1)

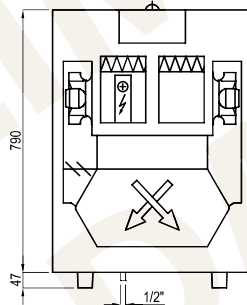

Shown as left (L1)

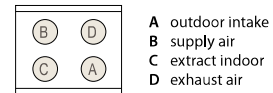
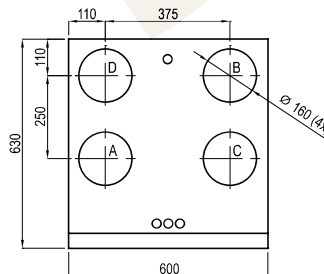

Performance

Unit with standard equipment

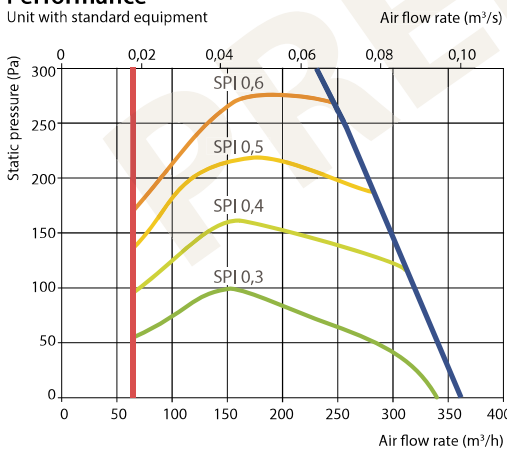

Accessories (p. 120)

Closing damper	AGUJ-M-160+LF230/LM230
Silencer	A/D AGS-160-50-600-M
	B/C AGS-160-50-900-M
Water heater	DH-160
PPU	PPU-HW-3R-15-0,4-W2

2-way valve (water heater)	VVP47.10-0,4
Water cooler	DCW-0,4-3 / DHCW-160
2-way valve (water cooler)	VVP47.10-1,6
DX cooler	DCF-0,4-3

Domekt CF 400 V

Maximal air flow, m ³ /h	390
Panel thickness, mm	30
Unit weight, kg	54
Supply voltage, V	1~230
Maximal operating current, A	HE 10.5
Thermal efficiency of heat recovery, %	88
Reference flow rate, m ³ /s	0,0758
Reference pressure difference, Pa	50
SPI, W/(m ³ /h)	0,22
Filters dimensions BxHxL, mm	350x235x46
Electric power input of the fan drive at reference flow rate, W	33
Electric power input of the fan drive at maximum flow rate, W	91
Electric air heater capacity, kW / Δt, °C	0,5 / 5,1
Electric preheater capacity, kW / Δt, °C	1,5 / 15,3
Control panel	C6.1 / 6.2
Maintenance space, mm	600



The photo is intended for informational purposes only. exact details may vary.



Acoustic data

A-weighted sound power level L_{WA,r} dB(A) at reference flow rate

Supply inlet	58
Supply outlet	53
Exhaust inlet	58
Exhaust outlet	53
Casing	41

A-weighted sound pressure level L_{PA,r} dB(A)

10 m² normally isolated room, distance from casing – 3 m.

Surroundings	31
--------------	----

Performance

Unit with standard equipment

Air flow rate (m³/s)

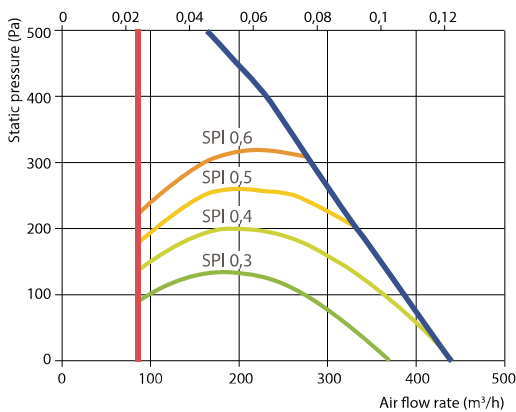

Temperature efficiency

	Winter					Summer		
Outside temperature, °C	-23	-15	-10	-5	0	25	30	35
After heat exchanger*, °C	17,4*	17,9*	17,9*	17,9	18,6	22,5	23,2	24,0

indoor +22°C, 20% RH.

* calculations made after evaluation of the preheater.

Shown as right (R1)

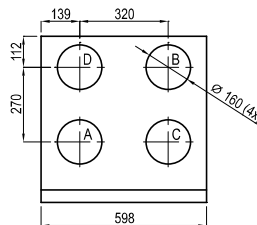
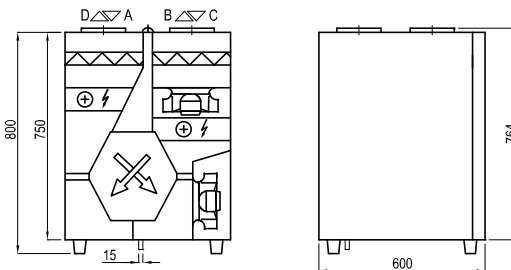

Shown as left (L1)

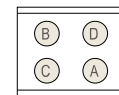

- A outdoor intake
- B supply air
- C extract indoor
- D exhaust air

Accessories (p. 120)

Closing damper	AGUJ-M-160+LF230/LM230
	A/D AGS-160-50-600-M
Silencer	B/C AGS-160-50-900-M
Water heater	DH-160
PPU	PPU-HW-3R-15-0,4-W1

2-way valve (water heater)	VVP47.10-0,4
Water cooler	DCW-0,4-3 / DHCW-160
2-way valve (water cooler)	VVP47.10-1,6
DX cooler	DCF-0,4-3

Domekt CF 500 F

Maximal air flow, m ³ /h	521
Panel thickness, mm	30
Unit weight, kg	93
Supply voltage, V	1~230
Maximal operating current, A	HE 11,7
Thermal efficiency of heat recovery, %	87
Reference flow rate, m ³ /s	0,1013
Reference pressure difference, Pa	50
SPI, W/(m ³ /h)	0,35
Filters dimensions BxHxL, mm	484x250x46
Electric power input of the fan drive at reference flow rate, W	67
Electric power input of the fan drive at maximum flow rate, W	171
Electric air heater capacity, kW / Δt, °C	0,5 / 3,8
Electric preheater capacity, kW / Δt, °C	1,5 / 11,4
Control panel	C6.1 / 6.2
Maintenance space, mm	520

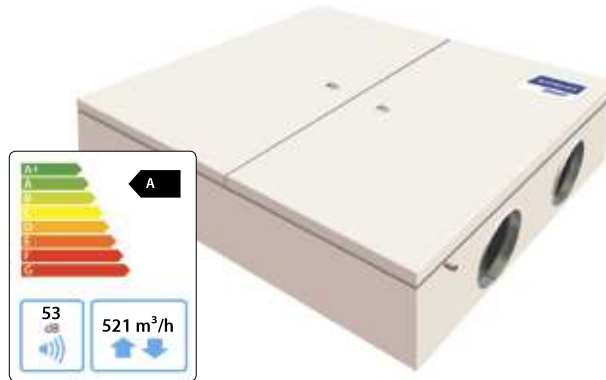

The photo is intended for informational purposes only. exact details may vary.

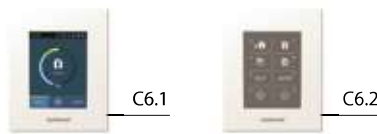

Acoustic data

A-weighted sound power level L_{WA}, dB(A)
at reference flow rate

Supply inlet	56
Supply outlet	70
Exhaust inlet	56
Exhaust outlet	70
Casing	53

A-weighted sound pressure level L_{PA}, dB(A)

10 m² normally isolated room, distance from casing – 3 m.

Surroundings	42
--------------	----

Temperature efficiency

Outside temperature, °C	Winter					Summer		
	-23	-15	-10	-5	0	25	30	35
After heat exchanger*, °C	17,4*	18,0*	18,2*	18,2	18,8	22,4	23,2	24,0

indoor +22°C, 20 % RH.

* calculations made after evaluation of the preheater.

Shown as right (R2)

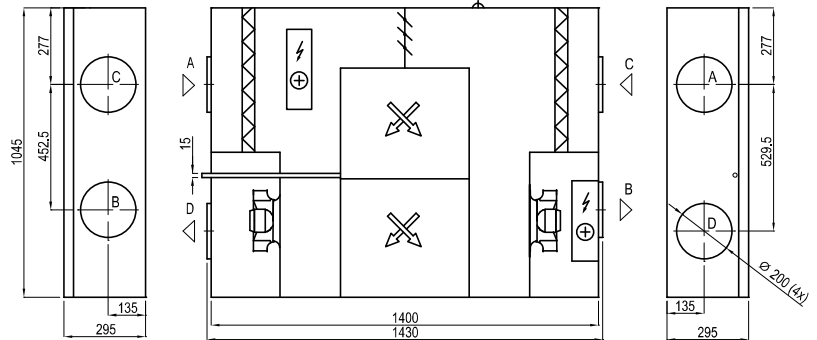

Shown as left (L2)

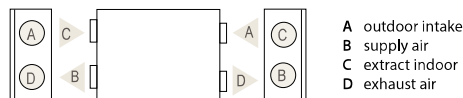

Performance

Unit with standard equipment

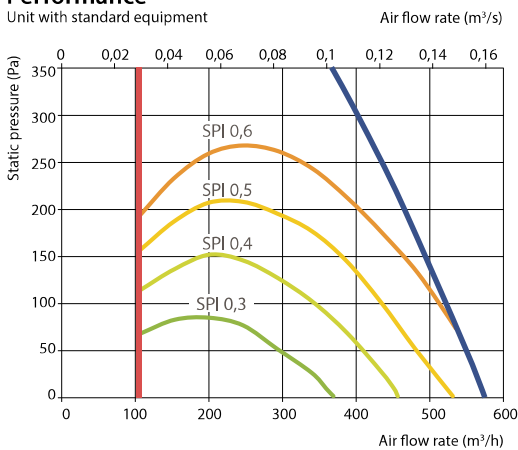

Accessories (p. 120)

Closing damper	AGUJ-M-200+LF230/LM230
Silencer	A/D AGS-200-50-600-M
	B/C AGS-200-50-900-M
Water heater	DH-200
PPU	PPU-HW-3R-15-0,4-W1

2-way valve (water heater)	VVP47.10-0,4
Water cooler	DCW-0,5-3 / DHCW-200
2-way valve (water cooler)	VVP47.10-1,6
DX cooler	DCF-0,5-3

Domekt CF 700 V

Maximal air flow, m ³ /h	637
Panel thickness, mm	50
Unit weight, kg	100
Supply voltage, V	1~230
Maximal operating current, A	HE 11,7
Thermal efficiency of heat recovery, %	88
Reference flow rate, m ³ /s	0,1239
Reference pressure difference, Pa	50
SPI, W/(m ³ /h)	0,30
Filters dimensions BxHxL, mm	390x300x46
Electric power input of the fan drive at reference flow rate, W	73
Electric power input of the fan drive at maximum flow rate, W	179
Electric air heater capacity, kW / Δt, °C	0,5 / 3,1
Electric preheater capacity, kW / Δt, °C	1,5 / 9,3
Control panel	C6.1 / 6.2
Maintenance space, mm	1000

Acoustic data

A-weighted sound power level L_{WA}, dB(A) at reference flow rate

Supply inlet	47
Supply outlet	67
Exhaust inlet	47
Exhaust outlet	67
Casing	47

A-weighted sound pressure level L_{PA}, dB(A) 10 m² normally isolated room, distance from casing – 3 m.

Surroundings	36
--------------	----

Performance

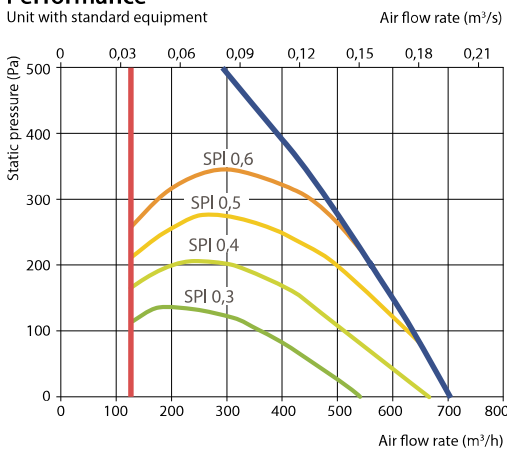

Accessories (p. 120)

Closing damper	AGUJ-M-200+LF230/LM230
	A/D AGS-200-50-600-M
Silencer	B/C AGS-200-50-900-M
	DH-200
Water heater	PPU-HW-3R-15-0,4-W1



The photo is intended for informational purposes only. exact details may vary.



Temperature efficiency

	Winter					Summer		
Outside temperature, °C	-23	-15	-10	-5	0	25	30	35
After heat exchanger*, °C	17,3*	17,9*	18,1*	18,1	18,8	22,4	23,2	23,9

indoor +22°C, 20% RH.
* calculations made after evaluation of the preheater.

Shown as left (L1)

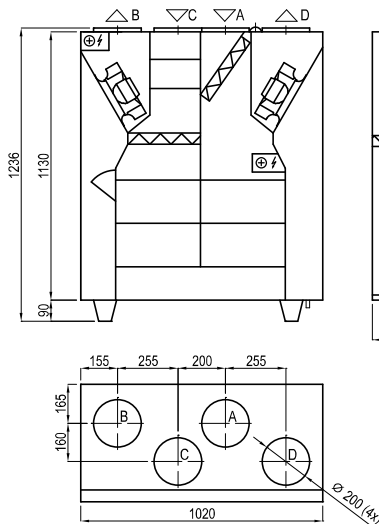

Shown as right (R1)

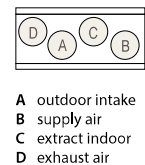

2-way valve (water heater)	VVP47.10-0,4
Water cooler	DCW-0,7-5 / DHCW-200
2-way valve (water cooler)	VVP47.15-2,5
DX cooler	DCF-0,7-5
Cooling unit	MOU-18HFN6-KA8243

Domekt CF 700 H

Maximal air flow, m ³ /h	651
Panel thickness, mm	50
Unit weight, kg	115
Supply voltage, V	1~230
Maximal operating current, A	HE 11,7
Thermal efficiency of heat recovery, %	88
Reference flow rate, m ³ /s	0,1266
Reference pressure difference, Pa	50
SPI, W/(m ³ /h)	0,29
Filters dimensions BxHxL, mm	390x300x46
Electric power input of the fan drive at reference flow rate, W	72
Electric power input of the fan drive at maximum flow rate, W	178
Electric air heater capacity, kW / Δt, °C	0,5 / 3,0
Electric preheater capacity, kW / Δt, °C	1,5 / 9,1
Control panel	C6.1 / 6.2
Maintenance space, mm	500

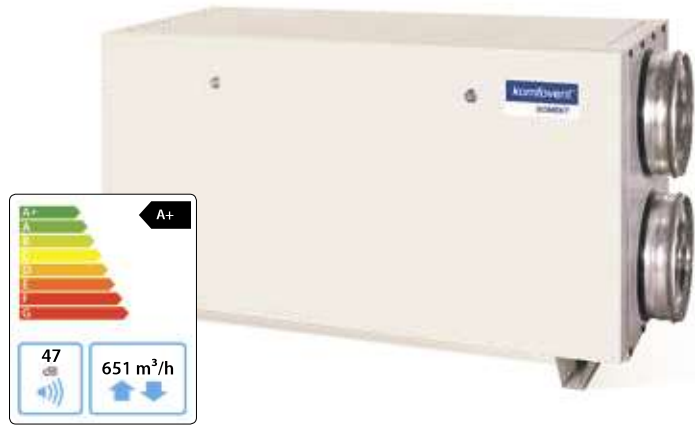

The photo is intended for informational purposes only. exact details may vary.

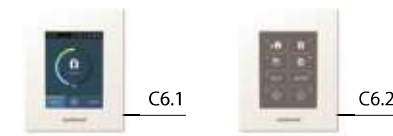

Acoustic data

A-weighted sound power level L_{WA} , dB(A) at reference flow rate

Supply inlet	47
Supply outlet	67
Exhaust inlet	47
Exhaust outlet	67
Casing	47

A-weighted sound pressure level L_{pM} , dB(A)

10 m² normally isolated room, distance from casing – 3 m.

Surroundings	36
--------------	----

Temperature efficiency

Outside temperature, °C	Winter					Summer		
	-23	-15	-10	-5	0	25	30	35
After heat exchanger*, °C	17,2*	17,7*	18,0*	18,0	18,8	22,4	23,2	23,9

indoor +22°C, 20 % RH.

* calculations made after evaluation of the preheater.

Performance

Unit with standard equipment

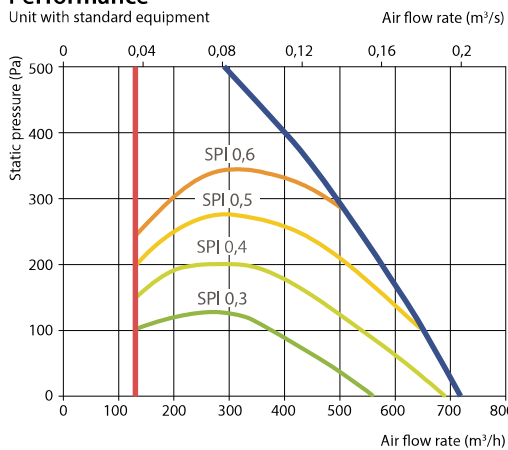

Shown as right (R1)

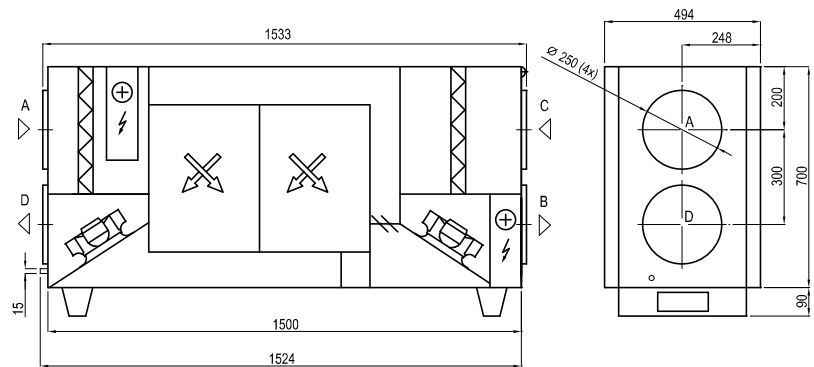

Shown as left (L1)



Accessories (p. 120)

Closing damper	AGUJ-M-250+LF230/LM230
Silencer	A/D AGS-250-50-600-M
	B/C AGS-250-50-900-M
Water heater	DH-250
PPU	PPU-HW-3R-15-0,63-W1

2-way valve (water heater)	VVP47.10-0,63
Water cooler	DCW-0,7-5 / DHCW-250
2-way valve (water cooler)	VVP47.15-2,5
DX cooler	DCF-0,7-5
Cooling unit	MOU-18HFN6-KA8243

Domekt CF 700 F

Maximal air flow, m ³ /h	720
Panel thickness, mm	30
Unit weight, kg	81
Supply voltage, V	1~230
Maximal operating current, A	HE 11,7
Thermal efficiency of heat recovery, %	82
Reference flow rate, m ³ /s	0,14
Reference pressure difference, Pa	50
SPI, W/(m ³ /h)	0,27
Filters dimensions BxHxL, mm	400x300x46
Electric power input of the fan drive at reference flow rate, W	70
Electric power input of the fan drive at maximum flow rate, W	177
Electric air heater capacity, kW / Δt, °C	0,5 / 2,8
Electric preheater capacity, kW / Δt, °C	1,5 / 8,3
Control panel	C6.1 / 6.2
Maintenance space, mm	450



The photo is intended for informational purposes only. exact details may vary.



Acoustic data

A-weighted sound power level L_{WA}, dB(A)
at reference flow rate

Supply inlet	53
Supply outlet	66
Exhaust inlet	53
Exhaust outlet	66
Casing	46

A-weighted sound pressure level L_{PA}, dB(A)

10 m² normally isolated room, distance from casing – 3 m.

Surroundings	35
--------------	----

Performance

Unit with standard equipment

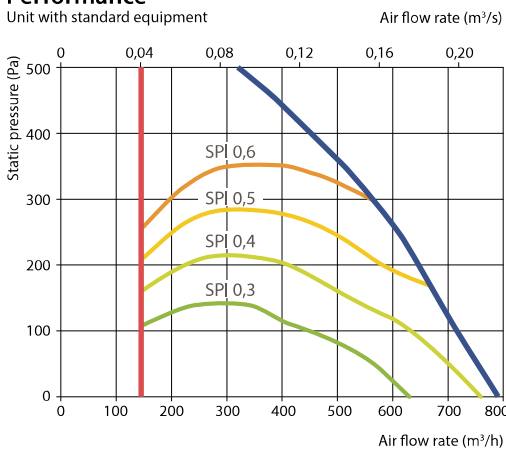

Temperature efficiency

Outside temperature, °C	Winter					Summer		
	-23	-15	-10	-5	0	25	30	35
After heat exchanger*, °C	15,5*	16,1*	16,8*	16,8	17,7	22,5	23,5	24,4

indoor +22°C, 20% RH.

* calculations made after evaluation of the preheater.

Shown as right (R1)

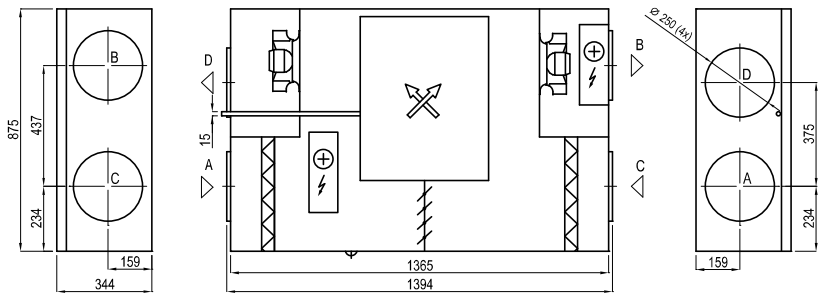

Shown as left (L1)

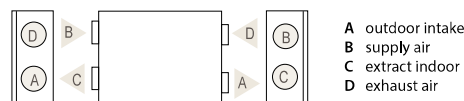

Accessories (p. 120)

Closing damper	AGUJ-M-250+LF230/LM230
	A/D AGS-250-50-600-M
Silencer	B/C AGS-250-50-900-M
	DH-250
Water heater	PPU-HW-3R-15-0,63-W1

2-way valve (water heater)	VVP47.10-0,63
Water cooler	DCW-0,7-5 / DHCW-250
2-way valve (water cooler)	VVP47.15-2,5
DX cooler	DCF-0,7-5
Cooling unit	MOU-18HFN6-KA8243

Domekt S

False ceiling supply air handling units

Sizes and capacities of Domekt S units

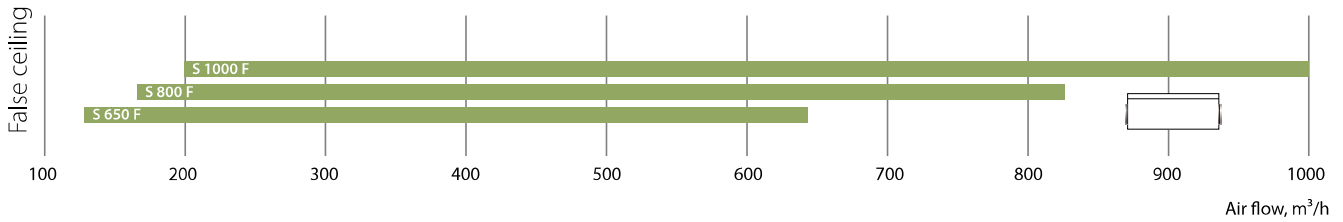

Modifications of Domekt S units

Unit	Supply / exhaust air filter class		Heater		Cooler		Inspection side		C5 panel
	F7	M5	HE	HW	CW	DX	R1	L1	C5.1
Domekt S 650 F	○	●	●		△	△	○	○	●
Domekt S 800 F	○	●	●	○	△	△	○	○	●
Domekt S 1000 F	○	●	●	○	△	△	○	○	●

● standard equipment ○ possible choice △ ordered separately duct heater/cooler

The markings are explained on p. 7.

Domekt S 650 F

Maximal air flow, m ³ /h	642
Panel thickness, mm	50
Unit weight, kg	35
Reference flow rate, m ³ /s	0,125
Reference pressure difference, Pa	50
SPI, W/(m ³ /h)	0,15
Filters dimensions BxHxL, mm	371x235x46
Electric power input of the fan drive at reference flow rate, W	63
Electric power input of the fan drive at maximum flow rate, W	172
Control panel	C5.1
Maintenance space, mm	300

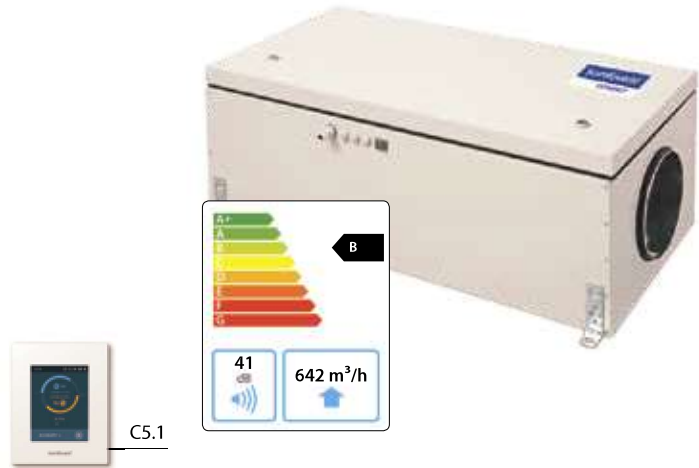

The photo is intended for informational purposes only. exact details may vary.

Acoustic data

A-weighted sound power level L_{WA} , dB(A) at reference flow rate

Supply inlet	63
Supply outlet	69
Casing	41

A-weighted sound pressure level L_{PA} , dB(A)

10 m² normally isolated room, distance from casing – 3 m.

Surroundings	30
--------------	----

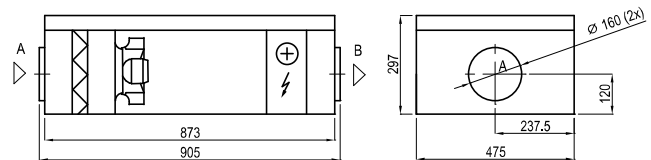

Performance

Unit with standard equipment

Air flow rate (m³/s)

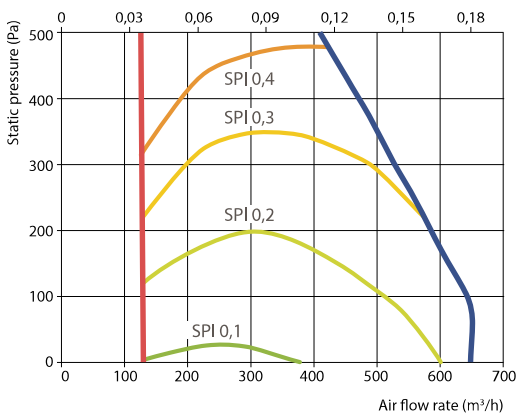

Technical data

Supply air handling unit	Supply voltage, V	Air heater capacity, kW	Maximal operating current, A	ΔT , °C
Domekt S 650 F-HE/3	1~230	3,0	14,7	13
Domekt S 650 F-HE/6	3~400	6,0	10,4	26

Accessories (p. 120)

Closing damper	AGUJ-M-160+LF24/LM24
Silencer	A AGS-160-50-600-M
	B AGS-160-50-900-M
PPU	-
Air heater-cooler	DCW-0,7-5
2-way valve	VVP47.15-2,5+SSP61
DX cooler	DCF-0,7-5
Cooling unit	MOU-18HFN6+KA8243

Domekt S 800 F

Maximal air flow, m ³ /h	826
Panel thickness, mm	50
Unit weight, kg	37
Reference flow rate, m ³ /s	0,161
Reference pressure difference, Pa	50
SPI, W/(m ³ /h)	0,14
Filters dimensions BxHxL, mm	371x287x46
Electric power input of the fan drive at reference flow rate, W	75
Electric power input of the fan drive at maximum flow rate, W	181
Control panel	C5.1
Maintenance space, mm	400

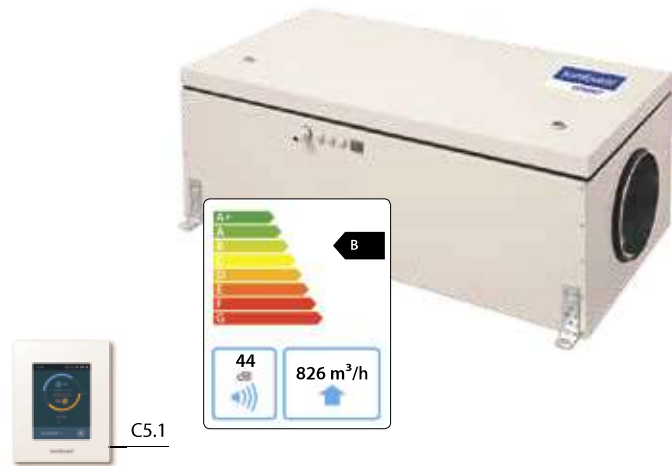

The photo is intended for informational purposes only. exact details may vary.

Acoustic data

A-weighted sound power level L_{WA} , dB(A)
at reference flow rate

Supply inlet	60
Supply outlet	65
Casing	44

A-weighted sound pressure level L_{PA} , dB(A)

10 m² normally isolated room, distance from casing – 3 m.

Surroundings	33
--------------	----

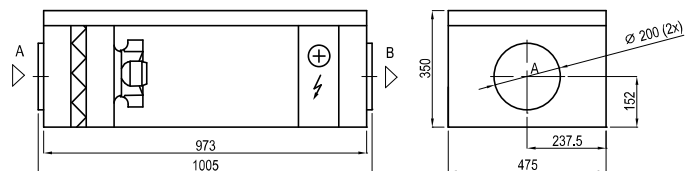

Performance

Unit with standard equipment

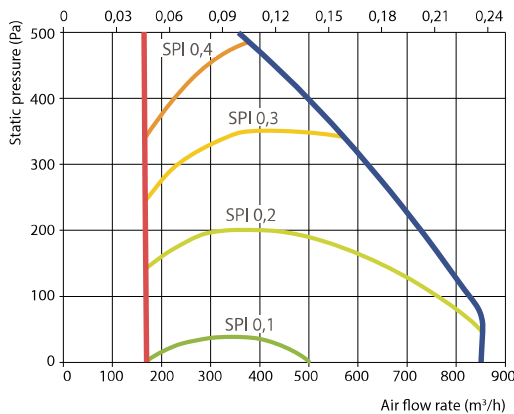

Technical data

Supply air handling unit	Supply voltage, V	Air heater capacity, kW	Maximal operating current, A	ΔT , °C
Domekt S 800 F-HE/6	3~400	6,0	10,3	20,2
Domekt S 800 F-HE/9	3~400	9,0	14,6	30,3
Domekt S 800 F-HW	1~230	-	1,9	-

Hot water air heater

Water temperature in/out, °C	80/60	70/50	60/40
Capacity, kW	6,3	5,2	4,1
Flow rate, dm ³ /h	277	230	181
Pressure drop, kPa	4,8	3,8	3
Temperature in/out, °C	-5/20,0	-5/15,9	-5/11,6
Maximal capacity, kW	6,3	5,2	4,1
Connection, "		½	

Accessories (p. 120)

Closing damper	AGUJ-M-200+LF24/LM24
Silencer	A AGS-200-50-600-M
	B AGS-200-50-900-M
PPU	PPU-HW-3R-15-1,6-W2
Air heater-cooler	DCW-0,9-6
2-way valve	VVP47.15-2,5+SSP61
DX cooler	DCF-0,9-6
Cooling unit	MOU-18HFN6-KA8243

Domekt S 1000 F

Maximal air flow, m ³ /h	1000
Panel thickness, mm	50
Unit weight, kg	46
Reference flow rate, m ³ /s	0,194
Reference pressure difference, Pa	50
SPI, W/(m ³ /h)	0,12
Filters dimensions BxHxL, mm	558x287x46
Electric power input of the fan drive at reference flow rate, W	82
Electric power input of the fan drive at maximum flow rate, W	182
Control panel	C5.1
Maintenance space, mm	400

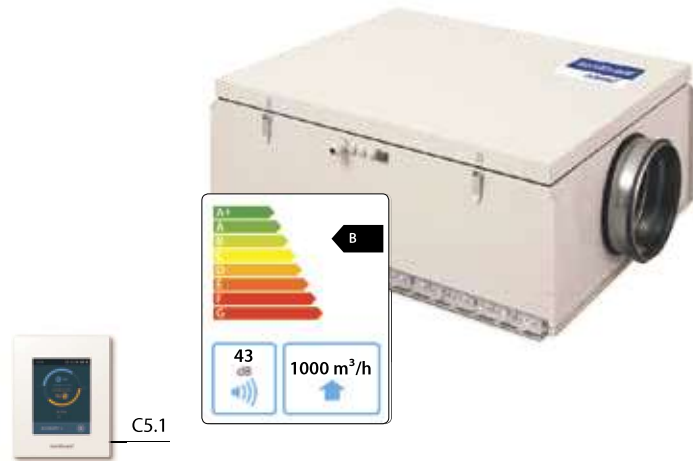

The photo is intended for informational purposes only. exact details may vary.

Acoustic data

A-weighted sound power level L_{WA}, dB(A) at reference flow rate

Supply inlet	60
Supply outlet	66
Casing	43

A-weighted sound pressure level L_{PA}, dB(A)

10 m² normally isolated room, distance from casing – 3 m.

Surroundings	32
--------------	----

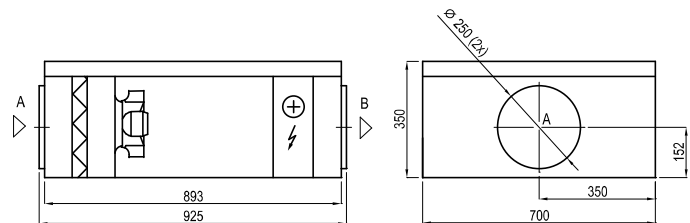

Performance

Unit with standard equipment

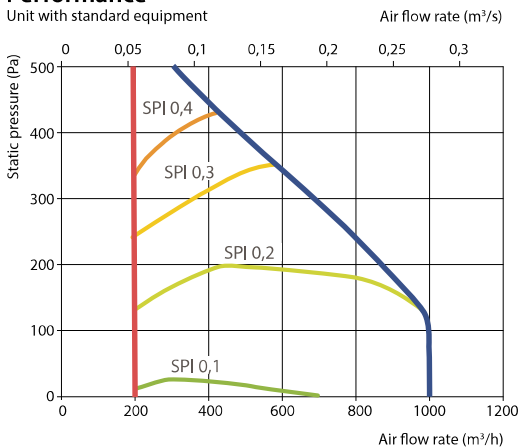

Technical data

Supply air handling unit	Supply voltage, V	Air heater capacity, kW	Maximal operating current, A	ΔT, °C
Domekt S 1000 F-HE/9	3~400	9,0	14,6	25
Domekt S 1000 F-HE/15	3~400	15,0	23,3	41,7
Domekt S 1000 F-HW	1~230	–	1,9	–

Hot water air heater

Water temperature in/out, °C	80/60	70/50	60/40
Capacity, kW	8,1	8,0	6,5
Flow rate, dm ³ /h	358	351	286
Pressure drop, kPa	8,1	7,9	6,0
Temperature in/out, °C	-5/20	-5/19,7	-5/15,2
Maximal capacity, kW	9,4	8,0	6,5
Connection, "		½	

Accessories (p. 120)

Closing damper	AGUJ-M-250+LF24/LM24
Silencer	A AGS-250-50-600-M
	B AGS-250-50-900-M
PPU	PPU-HW-3R-15-1.6-W2
Air heater-cooler	DCW-0,9-6
2-way valve	VVP47.15-2,5+SSP61
DX cooler	DCF-0,9-6
Cooling unit	MOU-18HFN6-KA8243